

Labor and Materials

..	Copper } Connection.....	3	1.75
..	Lead } .....	4	
..	Curb { Cock } .....	3	1.70
..	Valve } .....	4	
..	Service Box { Short 3 1/2 x 4 1/2 } .....		1.37
..	Old returned { Long 4 1/2 x 6 1/2 } .....		
9	Ft. 3/4 in. { Copper } Pipe at 12 1/2		1.22
..	Cast Iron } .....		
..	Nipples .....		
..	Bushings .....		
..	Red'g } Couplings.....		
..	Inc'g } .....		
..	Union.....		
..	Meter.....		
..	Lbs. Br. Stone at .....		
..	Lbs. Sand at .....		
..	Bags Cement at .....		
..	Paving Brick { Mack } at .....		
..	Red } .....		
..	Asphalt } .....		
..	Lead Joints at .....		
..	Leadite Joints at .....		
3	Hrs. Foreman at .....	6.22	1.89
8	Hrs. Common Labor at .....	50	1.50
8	Hrs. Common Labor at .....	15	3.60
..	Hrs. Mason at .....		
..	Hrs. Masons Helper at .....		
..	Hrs. Compressor at .....		
..	Compensation Ins .....		1.32
..	Trucking .....		1.15
..	Bullders Use of Water Patch .....		4.50
Total			70.94

1935-26

Labor and Material Report May 20 1935

51 Grove Ave

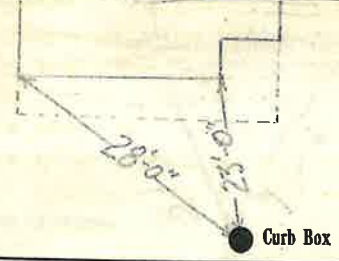

6 Main Elev. of Main at tap 5

Gate at ● Gate at ●

● Curb Box

Old tap shut off at main

*[Handwritten signature]*