

LABOR AND MATERIALS

1	Copper	} Connection	3/4"	\$		
	Lead			\$		
1	Curb	} Cock	3/4 in.	\$		
				} Valve	3/4 in.	\$
						T.S. & V.
1	Service box	} { Short 3 1/2 x 4 1/2		\$		
	Old returned			} { Long 4 1/2 x 5 1/2		\$
						} { Buff or Rdway
14	Ft. 3/4 in.	} { Copper		\$		
				} { G.I.		\$
						} { C.I.
	Nipples	in. at		\$		
	Bushings	to in. at		\$		
	Red'g	} Coupl'gs	to in. at	\$		
	Inc'g					
	Union	in. at		\$		
	Meter	in. at		\$		
	Lead Joints	at		\$		
	Compound Joints	at		\$		
	Maintenance Foreman			\$		
	Hrs. Water Maint. Man-1	at		\$		
	Hrs. Water Maint. Man-2	at		\$		
	Hrs. Garage Foreman	at		\$		
	Hrs. Labor	at		\$		
	Hrs. Compressor	at		\$		
	Compensation Ins. at \$	per C.		\$		
	Trucking			\$		
	Pav't Patch			\$		
	Tap by Gifford			\$		
	+ Co. 6-24-60			\$		
	O'head			\$		

Lot Tap

Halsey

St. Pl. Ave. No. 4

Name of Owner

Labor and Mat'l. Report June 24 19 60

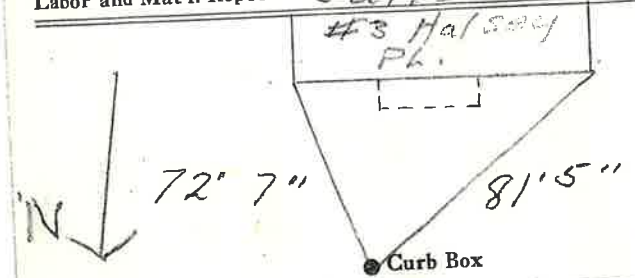

6" Main Elev. of Main at tap 5'

Gate at ● Gate at ●

● Curb Box

Lot Tap Measured From #3 Halsey Ph.