

LABOR AND MATERIALS

1	Copper Lead	Connection	1/2"		\$ 1.23
1	Curb	Cock Valve T.S. & V.	3/4" in.		\$ 1.68
1	Service Box Old returned	Short 3/2x4 1/2 Long 4 1/2x5 1/2 Buff. on Rdway			\$ 1.75
17	Ft.	3/4" in.		Pipe at 15	\$ 2.55
	Nipples	in. at			\$
	Bushings	to in. at			\$
	Red'g Inc'g	Couplings to in. at			\$
	Union	in. at			\$
	Meter	in. at			\$
	Lead Joints	at			\$
	Leadite Joints	at			\$
	Hrs. Foreman	at			\$
5	Hrs. Chauffeur	at	6 2/2		\$ 3.13
6	Hrs. Tapper	at	2		\$ 3.75
6	Hrs. Labor	at	45		\$ 2.70
	Hrs. Labor	at			\$
	Hrs. Compressor	at			\$
	Compensation Ins.				\$.30
	Trucking				\$ 1.00
	Builders Use' of Water	Patch			\$ 5.00
					\$
					\$
					\$
					\$
					\$
					\$
					\$
					\$ 23.09

1 3 9 - 1938

St. _____
Pl. _____
Ave. No. 28

Name of Owner
O'Connor

Labor and Mat'l. Report Oct 10 1938

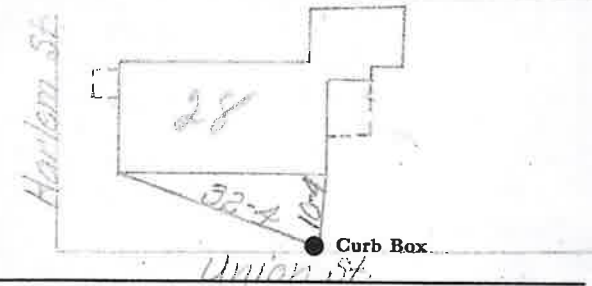

4" Gal. Main
Elev. of Main at tap _____
Gate at ● Gate at ●

● Curb Box

Renewal
Made by Penor.

LA