

LABOR AND MATERIALS

1 Copper Lead Connection $\frac{1}{2} \times \frac{3}{4}$ \$ 2.71

1 Curb Valve T.S. & V. $\frac{3}{4}$ in. \$ 3.83

Same Service Box

19 Old returned { Short $3\frac{1}{2} \times 4\frac{1}{2}$
Long $4\frac{1}{2} \times 5\frac{1}{2}$
Buff. or Rdway } \$ —

20 Ft. $\frac{3}{4}$ in. { Copper
Galv. Iron
Cast Iron } Pipe at 45 \$ 9.00

Nipples in. at \$

Bushings to in. at \$

Red'g } Couplings to in. at \$

Inc'g }

Union in. at \$

Meter in. at \$

Lead Joints at \$

Leadite Joints at \$

9 1/2 Hrs. Foreman at 1.51 \$ 14.35

9 1/2 Hrs. Chauffeur at mjm 2 1.24 \$ 11.78

2 Hrs. Tapper at 4 men = 1.59 \$ 3.18

Hrs. Labor at \$

21 Hrs. Labor at 1.13 \$ 23.73

Hrs. Compressor at \$

Compensation Ins. 5.886 \$ 3.02

Trucking \$ 1.50

Builders Use of Water \$ 7.20

Tap by Gifford \$

Miller & Co \$

2-10-56 \$

\$ 80.30

St. 10
Pt. Ave. No. 6

Harlem

Name of Owner

Phil. Rose

Labor and Mat'l. Report

Feb. 10 1956

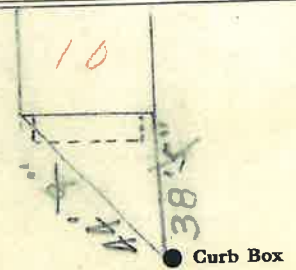

8" C.I.
3" gate

Elev. of Main at tap 5'

Gate at ● Gate at ●

● Curb Box

LABOR AND MATERIALS

Copper } Connection _____ \$ _____
 Lead }
 Curb } Cock Valve } _____ in. \$ _____
 T.S. & V. }
 Service box { Short 3-1/2 x 4-1/2 } _____ \$ _____
 Old returned { Long 4-1/2 x 5-1/2 }
 Ft. _____ in. { Copper } Pipe at _____ \$ _____
 { G.I. }
 { C.I. }
 Nipples _____ in. at _____ \$ _____
 Bushings _____ to _____ in. at _____ \$ _____
 Red'g _____
 Inc'g _____
 Union _____ in. at _____ \$ _____
 Meter _____ in. at _____ \$ _____
 _____ \$ _____
 Compound Joints at _____ \$ _____
 Maintenance Foreman _____ \$ _____
 Hrs. Water Maint. Man - 1 at _____ \$ _____
 Hrs. Water Maint. Man - 2 at _____ \$ _____
 Hrs. Garage Foreman _____ at _____ \$ _____
 Hrs. Labor _____ at _____ \$ _____
 Hrs. Compressor at _____ \$ _____
 _____ \$ _____
 Trucking _____ \$ _____
 Pav't Patch _____ \$ _____
 _____ \$ _____
 _____ \$ _____
 _____ \$ _____
 _____ \$ _____
 _____ \$ _____

HARLEM St. Pt. Ave. No. 10

Name of Owner CLEAN OUT

Labor and Mat'l. Report 10 / 2017

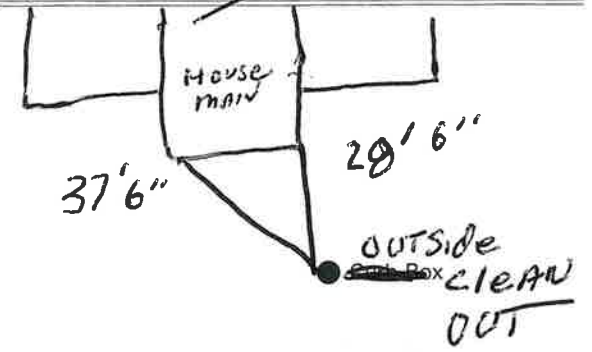

_____ Main Elev. of Main at tap _____

Gate at ● Gate at ●

● Curb Box