

LABOR AND MATERIALS

1	Copper Lead	} Connection $\frac{3}{4}$		\$ 2.80
1	Curb	{ Clock Valve T. S. & V. }	$\frac{3}{4}$ in.	\$ 3.60
1	Service box Old returned	{ Short $3\frac{1}{2}$ X $4\frac{1}{2}$ Long $4\frac{1}{2}$ X $5\frac{1}{2}$ Buff or Rdway }		\$ 5.80
18	Ft.	$\frac{3}{4}$ in.	{ Copper Galv. Iron Cast Iron }	Pipe at 35 \$ 6.30
	Nipples	in. at		\$
	Bushings	to in. at		\$
	Red'g Inc'g	{ Couplings	to in. at	\$
	Union	in. at		\$
	Meter	in. at		\$
	Lead Joints	at		\$
	Compound Joints	at		\$
6	Hrs. Foreman	at		\$
6	Hrs. Chauffeur	at 91		\$ 5.46
	Hrs. Tapper	at		\$
12	Hrs. Labor	at 80		\$ 9.60
	Hrs. Labor	at		\$
	Hrs. Compressor	at		\$
	Compensation Ins.			\$ 3.33
	Trucking			\$ 1.00
	Builders Use of Water			\$ 7.80
Tape by <u>WIKUSINSKI</u>				\$
				\$
				\$
				\$
				\$ 42.69

104 / 47

St.
Pl.
Ave. No. 24

Name of Owner

Marauville

Labor and Mat'l. Report Aug 18 1917

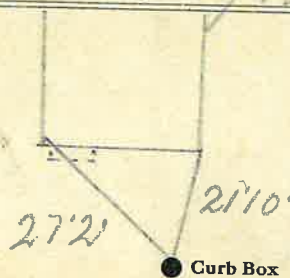

4 Main

Elev. of
Main at tap 6

Gate at ●

● Gate at

● Curb Box