

### LABOR AND MATERIALS

Copper	}	Connection			\$	
Lead						
Curb	{	Cock Valve T. S. & V.		in.	\$	
Service Box			{	Short 3 1/2 x 4 1/2 Long 4 1/2 x 5 1/2 Buff. or Rdway		\$
Old returned						
Ft.	}	{		in.	\$	
Nipples				in. at	\$	
Bushings				to in. at	\$	
Red'g Inc'g	{	Couplings		to in. at	\$	
Union				in. at	\$	
Meter				in. at	\$	
Lead Joints					\$	
Leadite Joints					\$	
Hrs. Foreman					\$	
Hrs. Chauffeur					\$	
Hrs. Tapper					\$	
Hrs. Labor					\$	
Hrs. Labor					\$	
Hrs. Compressor					\$	
Compensation Ins.					\$	
Trucking					\$	
Builders Use of Water					\$	
					\$	
					\$	
					\$	
					\$	

-St.  
-Pl.

*Harrison* Ave. No. 18

Name of Owner \_\_\_\_\_

Labor and Mat'l. Report 19 12

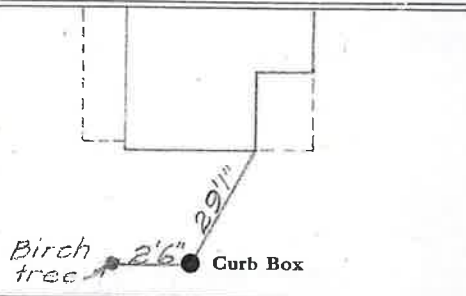

Main Elev. of  
Main at tap

---

Gate at ● ● Gate at

● Curb Box

# LABOR AND MATERIALS

3/4 Copper } on Homeowners Side  
 Lead } Connection }  
 Curb } Cock Valve } in. \$  
       } T.S. & V. }  
 Service box { Short 3-1/2 x 4-1/2 } \$  
 Old returned { Long 4-1/2 x 5-1/2 }  
 Ft. in. { Copper } Pipe at \$  
           } G.I. }  
           } C.I. }  
 Nipples \_\_\_\_\_ in. at \$  
 Bushings \_\_\_\_\_ to \_\_\_\_\_ in. at \$  
 Red'g \_\_\_\_\_  
 Inc'g \_\_\_\_\_  
 Union \_\_\_\_\_ in. at \$  
 Meter \_\_\_\_\_ in. at \$  
 \_\_\_\_\_ \$  
 Compound Joints at \$  
 Maintenance Foreman \$  
 Hrs. Water Maint. Man - 1 at \$  
 Hrs. Water Maint. Man - 2 at \$  
 Hrs. Garage Foreman \_\_\_\_\_ at \$  
 Hrs. Labor \_\_\_\_\_ at \$  
 Hrs. Compressor at \$  
 \_\_\_\_\_ \$  
 Trucking \_\_\_\_\_ \$  
 Pav't Patch \_\_\_\_\_ \$  
 \_\_\_\_\_ \$  
 \_\_\_\_\_ \$  
 \_\_\_\_\_ \$  
 \_\_\_\_\_ \$  
 \_\_\_\_\_ \$

Harrison Ave St. \_\_\_\_\_  
 Pl. \_\_\_\_\_  
 Ave. No. 18

Name of Owner \_\_\_\_\_

Labor and Mat'l. Report 19 \_\_\_\_\_

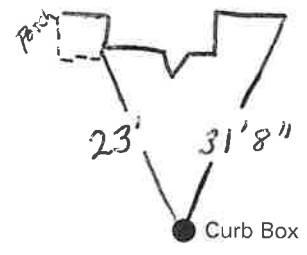

\_\_\_\_\_ Main Tap on Davis Elev. of Main at tap \_\_\_\_\_  
 Gate at ● \_\_\_\_\_ ● Gate at \_\_\_\_\_

● Curb Box

Slip 4" pvc for sewer to curb  
 with clean out up by house. also  
 Conges out to Davis