

LABOR AND MATERIALS

1	Copper Lead	{ Connection	3/4	\$	2.29
1	Curb	{ Cock Valve T.S. & V.	3/4 in.	\$	2.70
	Service box Old returned	{ Short 3 1/2 x 4 1/2 Long 4 1/2 x 5 1/2 Buff or Rdway	same	\$	—
9	Ft. 3/4 in.	{ Copper C.I. C.I.	Pipe at 35	\$	315
	Nipples	in. at		\$	
	Bushings	to in. at		\$	
	Red'g Inc'g	{ Coupl'gs to in. at		\$	
	Union	in. at		\$	
	Meter	in. at		\$	
	Lead Joints at			\$	
	Compound Joints at			\$	
2	Hrs. Water Maint. Man-1	at 1.12	\$	2.24	
2	Hrs. Water Maint. Man-2	at 1.02	\$	2.04	
8	Hrs. Labor	at 91	\$	728	
	Hrs. Labor	at	\$		
	Hrs. Compressor at		\$		
	Compensation Ins. at \$	per C.	\$	26	
	Trucking		\$	1.00	
	Pav't Patch	B.P.	\$	—	
	Top 4 Miller		\$		
	O'head		\$		
			\$	20.96	

Harrison

Ave. No. 33

Name of Owner

Graham Bell

Labor and Mat'l. Report

June 19 1950

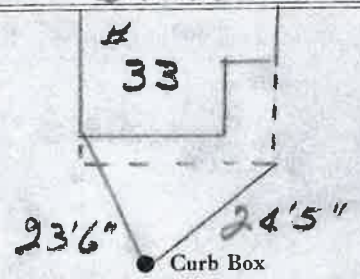

4 Main

Elev. of Main at tap 4 1/2

Gate at ●

● Gate at

● Curb Box

18 h 1/2 1100