

LABOR AND MATERIALS

1	Copper	Connection	3/4	\$	2.29
1	Lead			\$	
1	Curb	Cock Valve F.S. & V.	3/4 in.	\$	2.70
1	Service box Old returned	Short 3 1/2 x 4 1/2 Long 4 1/2 x 5 1/2 Buff or Rdway		\$	4.25
29	Ft.	Copper Pipe	3/4 in.	\$	10.15
	Nipples	in. at		\$	
	Bushings	to in. at		\$	
	Red'g Inc'g	Coupl'gs to in. at		\$	
	Union	in. at		\$	
	Meter	in. at		\$	
	Lead Joints	at		\$	
	Compound Joints	at		\$	
	Hrs. Water Maint. Man-1	at		\$	
2	Hrs. Water Maint. Man-2	at	1.02	\$	2.04
12	Hrs. Labor	at	91	\$	10.92
	Hrs. Labor	at		\$	
	Hrs. Compressor	at		\$	
	Compensation Ins.	at \$ per C.		\$	29
	Trucking			\$	1.00
	Pav't Patch	B.P.		\$	
		Lap by Muzina		\$	
	O'head			\$	
				\$	3364

Harrison ~~St.~~  
~~Pl.~~ Ave. No. 38

Name of Owner  
 Bates Hickey

Labor and Mat'l. Report June 16 1950

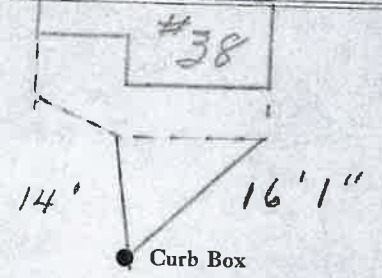

4 Main Elev. of Main at tap 4 1/2  
 Gate at ● Gate at ●

● Curb Box

pd.