

Labor and Materials

1. Copper } Connection 3/4"	\$ 1.33
1. Lead }
1. Curb { Cock Valve } 3/4" in	\$ 1.58
{ T.S.&V. }
1. Service Box { Short 3/4x4 1/2 }	\$ 1.36
Old returned { Long 1 1/2x5 1/2 }
{ Buff. or Rdway }
26 Ft. 3/4" in. { Copper } Pipe at	\$ 2.47
{ Galv. Iron }
{ Cast Iron }
..... Nipples in. at	\$
..... Bushings to in. at	\$
..... Red'g } Couplings to in. at	\$
..... Inc'g }
..... Union in. at	\$
..... Meter in. at	\$
..... Lbs. Br. Stone at	\$
..... Lbs. Sand at	\$
..... Bags Cement at	\$
..... Paving Brick { Mack } at	\$
{ Red }
{ Asphalt }
..... Lead Joints at	\$
..... Leadite Joints at	\$
15 1/2 Hrs. Foreman at	\$ 9.68
8 Hrs. Common Labor at Tapper	\$ 4.00
..... Hrs. Common Labor at	\$
..... Hrs. Mason at	\$
..... Hrs. Masons Helper at	\$
..... Hrs. Compressor at	\$
..... Compensation Ins	\$ 4.2
..... Trucking	\$ 5.00
..... Builders Use of Water Patch	\$ 5.00
Total \$ 26.94	

33-33 Lot 200

Labor and Material Report 16 1937

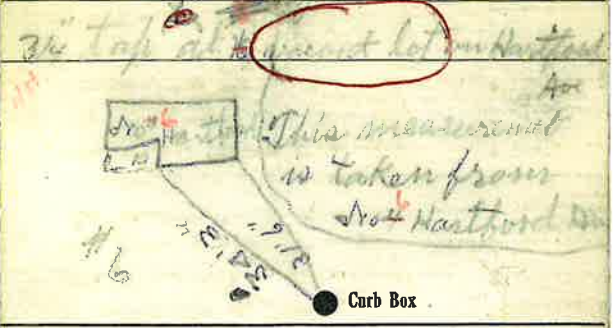

4 Main Elev. of Main at tap 44.5

Gate at ● Gate at ●

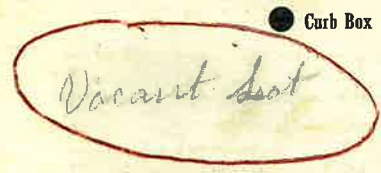

OK 11/11
This is '36