

### LABOR AND MATERIALS

1	Copper Lead	{ Connection	2"		\$ 21.03
1	Curb	{ Cock Valve F.S. & V.	2" in.		\$ 20.53
1	Service box Old returned	{ Short 3 1/2 x 4 1/2 Long 4 1/2 x 5 1/2 Buff or Rdway			\$ 10.00
48	Ft. 2" in.	{ Copper G.I. C.I.	Pipe at	9 1/4	\$ 43.80
	Nipples	in. at			\$
	Bushings	to in. at			\$
2	Red'g Inc'g	{ Coupl'gs	2" to	97	\$ 1.94
	Union	in. at			\$
	Meter	in. at			\$
	Lead Joints at				\$
	Compound Joints at				\$
10	Hrs. Water Maint. Man-1	at	1.12		\$ 11.20
	Hrs. Water Maint. Man-2	at			\$
5	Hrs. Labor	at	91		\$ 4.55
	Hrs. Labor	at			\$
	Hrs. Compressor at				\$
	Compensation Ins. at \$	2.226 per C.			\$ 3.5
	Trucking				\$ 1.00
	Pav't Patch				\$
2	Excavator - O'Connor		12.50		\$ 25.00
2500	Bulk Dozee	"	6.00		\$ 4.00
	O'head				\$
					\$ 143.40

3/5 Tap by Miller

10-15-50

St. Portland  
Pl. 3-4-5  
Ave. No. 3-4-5

Hartford

Name of Owner

Colonial Garden Apts.

Labor and Mat'l. Report

June 29 1950

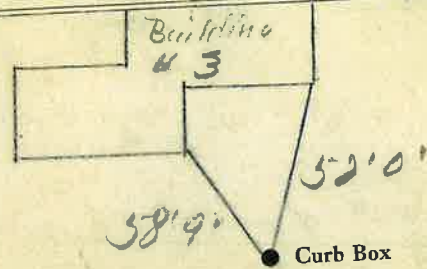

6" Main

Elev. of  
Main at tap 5

Gate at ●

● Gate at

● Curb Box