

Labor and Materials

1..Copper } Connection. ^{3/4"}	\$ 1.75
1..Lead }	
1..Curb { Cock Valve } ^{3/4"} in	\$ 1.70
	T.S.&V.
1..Service Box { Short 3 1/2 x 4 1/2 }	\$ 1.37
Old returned { Long 4 1/2 x 5 1/2 }	
	Buff. or Raway
24 Ft. ^{3/4"} in. { Copper Galv. Iron } Pipe at ^{13 1/2}	\$ 3.70
	Cast Iron
.....Nipplesin. at	\$
.....Bushingstoin. at.....	\$
.....Red'g Inc'g } Couplings.....to.....in.at.....	\$
.....Union.....in. at	\$
.....Meter.....in. at	\$
.....Lbs. Br. Stone at	\$
.....Lbs. Sand at	\$
.....Bags Cement at	\$
.....Paving Brick { Mack Red Asphalt } at	\$
.....Lead Joints at	\$
.....Leadite Joints at	\$
3..Hrs. Foreman at ^{62 1/2}	\$ 1.88
2..Hrs. Common Labor at ⁵⁰	\$ 4.-
5..Hrs. Common Labor at ⁴⁵	\$ 3.60
.....Hrs. Mason at	\$
.....Hrs. Masons Helper at	\$
.....Hrs. Compressor at	\$
.....Compensation Ins	\$ 3.6
.....Trucking	\$ 1.-
.....Builders Use of Water	\$
Total \$ 13.40	

35' tap at 30' Haskell Ave

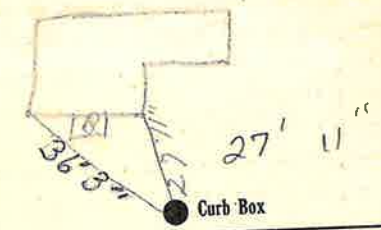

6" Main Elev of Main at tap ^{24 1/2}

Gate at ● ● Gate at

● Curb Box

Old tap shut off of main

MB