

Labor and Materials

1	Copper	Connection	3/4		\$ 3.20
1	Curb	Cock Valve T-S. & V.	3/4	in.	\$ 1.00
1	Service Box	Short 3 1/2 x 4 1/2			\$ 1.30
	Old returned	Long 4 1/2 x 5 1/2		Buff. or Rdway	
2.6	Ft.	3/4 in. Copper Galv-Iron Cast-Iron		Pipe at	\$ 5.72
	Nipples			in. at	\$
	Bushings			to in. at	\$
1	Red'g Inc'g	Couplings	3/4	to in. at	\$ 1.50
	Union			in. at	\$
	Meter			in. at	\$
	Lbs. Br. Stone	at			\$
	Lbs. Sand	at			\$
	Bags Cement	at			\$
	Paving Brick	Mack Red Asphalt		at	\$
	Lead Joints	at			\$
	Leadite Joints	at			\$
6	Hrs. Foreman	at	62.5		\$ 3.75
19	Hrs. Common Labor	at	50		\$ 9.50
19	Hrs. Common Labor	at	4.0 5/8		\$ 7.72
	Hrs. Mason	at			\$
	Hrs. Mason's Helper	at			\$
	Hrs. Compressor	at			\$
	Compensation Ins.				\$ 1.50
	Trucking				\$ 1.00
	Builders' Use of Water				\$

Total \$ 33.90

Labor and Material Report

June 16 1936

no. 34 Washel Ave

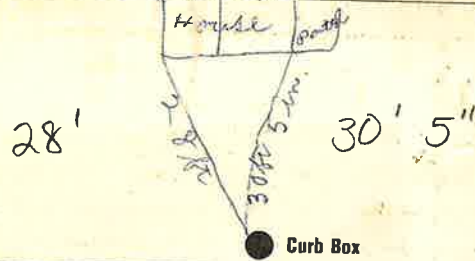

6" Main Elev. of Main at tap 6"

Gate at ● ● Gate at

● Curb Box

old tap to be dug up.