

LABOR AND MATERIALS

1	Copper	} Connection	3/4"	\$	_____
1	Lead				
1	Curb	} Cock Valve	3/4 in.	\$	_____
1	Service box	} { Short 3 1/2 x 4 1/2 Long 4 1/2 x 5 1/2 Buff-or-Rdway		\$	_____
	Old returned				
30	Ft. 3/4 in.				
	Nipples	in. at		\$	_____
	Bushings	to in. at		\$	_____
	Red'g	} Coupl'gs	to in. at	\$	_____
	Inc'g				
	Union	in. at		\$	_____
	Meter	in. at		\$	_____
	Lead Joints	at		\$	_____
	Compound Joints	at		\$	_____
	Maintenance Foreman			\$	_____
	Hrs. Water Maint. Man	1 at		\$	_____
	Hrs. Water Maint. Man	2 at		\$	_____
	Hrs. Garage Foreman	at		\$	_____
	Hrs. Labor	at		\$	_____
	Hrs. Compressor	at		\$	_____
	Compensation Ins.	at \$ _____ per C		\$	_____
	Trucking			\$	_____
	Pav't Patch			\$	_____
	Tap by Giggard			\$	_____
	4 Cb. 7-19-61.			\$	_____
	O'head			\$	_____
				\$	_____

St. _____
 Pl. _____
 Ave. No. 74
 Name of Owner Robt. Deanner.

Labor and Mat'l. Report July 19 19 61

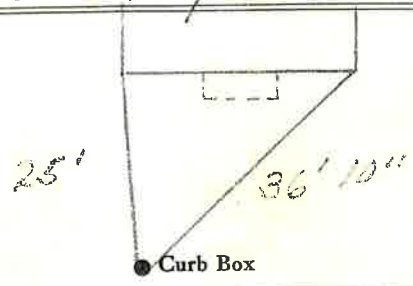

6" Main Elev. of Main at tap _____
 Gate at • Gate at •

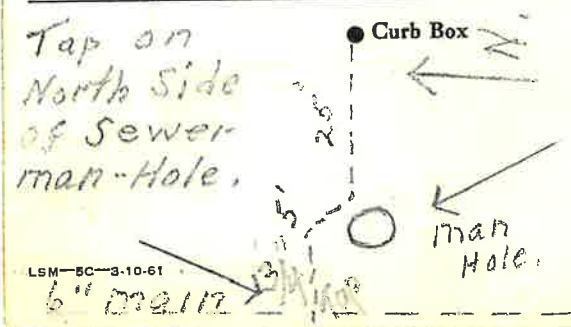

LSM-BC-3-10-61