

LABOR AND MATERIALS

1	Copper Lead	} Connection	3/4"	\$	
1	Curb		3/4" Valve T.S. & V.	\$	
1	Service box	} Short 3 1/2 x 4 1/2			
	Old returned		Long 4 1/2 x 5 1/2		
			Buff or Rdway	\$	
26	Ft.	} Copper	3/4" in.		
			G. I.	Pipe at	\$
			C. I.		
	Nipples	in. at		\$	
	Bushings	to in. at		\$	
	Red'g Inc'g	} Coupl'gs	to in. at	\$	
	Union		in. at		\$
	Meter	in. at		\$	
	Lead Joints at			\$	
	Compound Joints at			\$	
	Maintenance Foreman			\$	
	Hrs. Water Maint. Man-1 at			\$	
	Hrs. Water Maint. Man-2 at			\$	
	Hrs. Garage Foreman at			\$	
	Hrs. Labor— at			\$	
	Hrs. Compressor at			\$	
	Compensation Ins. at \$	per C		\$	
	Trucking			\$	
	Pav't Patch			\$	
	Tap Bulb 1/4" Spool 1/2" Cap			\$	
	1 1/2" - 1 1/4" - 1/2"			\$	
	O'head			\$	

St. _____
 Pl. _____
 Ave. No. 52

Name of Owner
Terry P. ...

Labor and Mat'l. Report 19

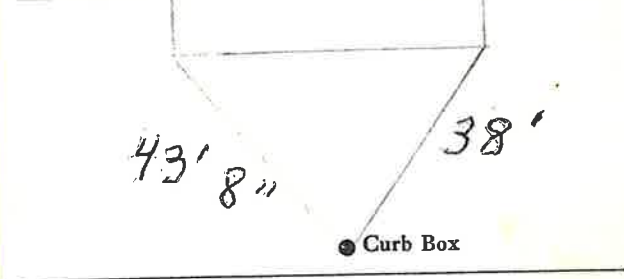

8" Main Elev. of Main at tap 5'
 Gate at • Gate at •

• Curb Box