

LABOR AND MATERIALS

2 ¹¹ Copper Lead	} Connection	_____	\$ _____
Curb		} Cock Valve T. S. & V.	_____ in. \$ _____
Service box	} Short 3 1/2 x 4 1/2 } Long 4 1/2 x 5 1/2 }		_____
Old returned			_____
35' Ft. 2 in.	} Copper } Cast Cast	Pipe at _____	\$ _____
Nipples _____ in.		at _____	\$ _____
Bushings _____ to _____ in.	at _____	\$ _____	
Red'g } Inc'g }	} Coupl'gs _____ to _____ in.	at _____	\$ _____
Union _____ in.		at _____	\$ _____
Meter _____ in.	at _____	\$ _____	
Compound Joints	at _____	\$ _____	
Maintenance Foreman	_____	\$ _____	
Hrs. Water Maint. Man-1	at _____	\$ _____	
Hrs. Water Maint. Man-2	at _____	\$ _____	
Hrs. Garage Foreman	at _____	\$ _____	
Hrs. Labor	at _____	\$ _____	
Hrs. Compressor	at _____	\$ _____	
Trucking	_____	\$ _____	
Pav't Patch	_____	\$ _____	
		\$ _____	
		\$ _____	
		\$ _____	

WAREHOUSE/HENRY St. No. 5
Pl. Ave. No.

Name of Owner
FINCH & PRYUN

Labor and Mat'l. Report 1995

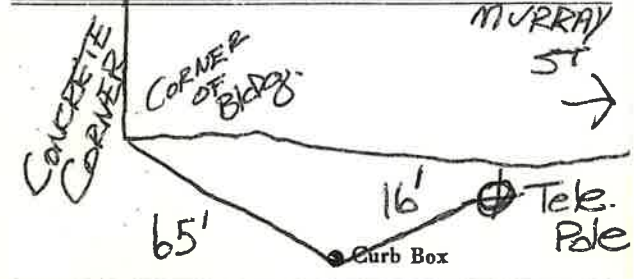

6" Main Elev. of Main at tap 5'

Gate at • Gate at •

• Curb Box
NO # ON
TELE.
POLE

LSM-5C-6-1-67
12" HIGH PRESSURE GAS MAIN ON
Street Side of Box

LABOR AND MATERIALS

Copper	} Connection	_____	\$	_____
Lead				
Curb	} Cock Valve T. S. & V.	_____ in.	\$	_____
Service box		} Short 3 1/2 x 4 1/2 } Long 4 1/2 x 5 1/2 }		
Old returned				\$
Ft. _____ in.	} Copper } G. I. } C. I. }	Pipe at _____	\$	_____
Nipples _____ in.		at _____	\$	_____
Bushings _____ to _____ in.	at _____	\$	_____	
Red'g } Inc'g }	} Coupl'gs _____ to _____ in.	at _____	\$	_____
Union _____ in.		at _____	\$	_____
Meter _____ in.	at _____	\$	_____	
_____			\$	_____
Compound Joints	at _____	\$	_____	
Maintenance Foreman	_____	\$	_____	
Hrs. Water Maint. Man—1	at _____	\$	_____	
Hrs. Water Maint. Man—2	at _____	\$	_____	
Hrs. Garage Foreman	at _____	\$	_____	
Hrs. Labor	at _____	\$	_____	
Hrs. Compressor	at _____	\$	_____	
_____			\$	_____
Trucking	_____	\$	_____	
Pav't Patch	_____	\$	_____	
_____			\$	_____
_____			\$	_____
_____			\$	_____
_____			\$	_____

12" SPRINKLER VALVE
FINCH & FRYON
WAREHOUSE

St. HENRY
Pl. ST
Ave. No. 5

Name of Owner

FINCH & FRYON

Labor and Mat'l. Report

Nov-1995

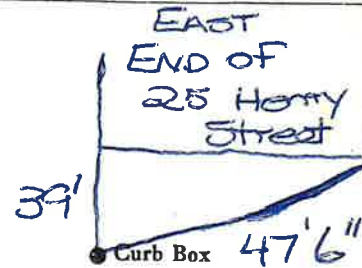

MURRAY ST

12" Main

Elev. of Main at tap 6'

Gate at ●

● Gate at

● Curb Box

TAP ON MURRAY ST