

Labor and Materials

3/4" Lead	Copper } Connection.....	\$ 320
3/4" A	Curb { Cock }	\$ 1.00
	{ Valve }	
	{ T.S. & V. }	
	Service Box { Short 3" x 4" }	\$ 1.40
	{ Long 4" x 5" }	
	Old returned { Buff. or Rdway }	
16 Ft. 3/4" A	{ Copper } Pipe at.....	\$ 352
	{ Galv. Iron }	
	{ Cast Iron }	
	Nipples..... in. at.....	\$
	Bushings..... to..... in. at.....	\$
	Red'g } Couplings..... to..... in. at.....	\$
	Inc'g }	
	Union..... in. at.....	\$
	Meter..... in. at.....	\$
	Lbs. Br. Stone at.....	\$
	Lbs. Sand at.....	\$
	Bags Cement at.....	\$
	Paving Brick { Mack } at.....	\$
	{ Red }	
	{ Asphalt }	
	Lead Joints at.....	\$
	Leadite Joints at.....	\$
2	Hrs. Foreman at.....	\$ 125
8	Hrs. Common Labor at.....	\$ 325
	Hrs. Common Labor at.....	\$
	Hrs. Mason at.....	\$
	Hrs. Mason's Helper at.....	\$
	Hrs. Compressor at.....	\$
	Compensation Ins.....	\$ 12
1	Trucking.....	\$ 150
	Builders' Use of Water.....	\$
	Total	\$ 1474

Labor and Material Report

July 19

1927

3/4" Tap Horicon Ave Ext

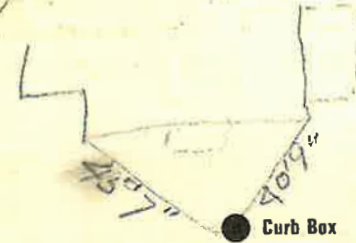

6" Main

Elev. of Main at tap

Gate at ●

● Gate at

● Curb Box

3/4" tap on Upper Horicon Ave

47' 10" 39' 9"