

Labor and Materials

Copper } Connection.....	$\frac{3}{4}$ "	\$ 3.20	
Curb } Cock	} $\frac{3}{4}$ " in.	\$ 1.00	
Valve			
Service Box } Short 2' x 4'	}	\$ 1.40	
Old returned } Long 4' x 5'			
Buff. or Rdway			
20 Ft. } $\frac{3}{4}$ " in. } Copper	} Pipe at.....	\$ 4.40	
			Galv. Iron
			Cast Iron
Nipples.....	in. at.....	\$	
Bushings.....	to..... in. at.....	\$	
Red'g } Couplings.....	to..... in. at.....	\$	
Inc'g			
Union.....	in. at.....	\$	
Meter.....	in. at.....	\$	
Lbs. Br. Stone at.....		\$	
Lbs. Sand at.....		\$	
Bags Cement at.....		\$	
Paving Brick } Mack	} at.....	\$	
			Red
			Asphalt
Lead Joints at.....		\$	
Leadite Joints at.....		\$	
3 Hrs. Foreman at.....	62.5-	\$ 1.87	
Hrs. Common Labor at.....		\$	
5 Hrs. Common Labor at.....	20.7	\$ 2.03	
Hrs. Mason at.....		\$	
Hrs. Mason's Helper at.....		\$	
Hrs. Compressor at.....		\$	
Compensation Ins.....		\$ 11	
Trucking.....		\$ 1.00	
Builders' Use of Water.....		\$	
Total		\$ 15.01	

26-13

39

April 29

19 24

Labor and Material Report

29 Hudson Ave.

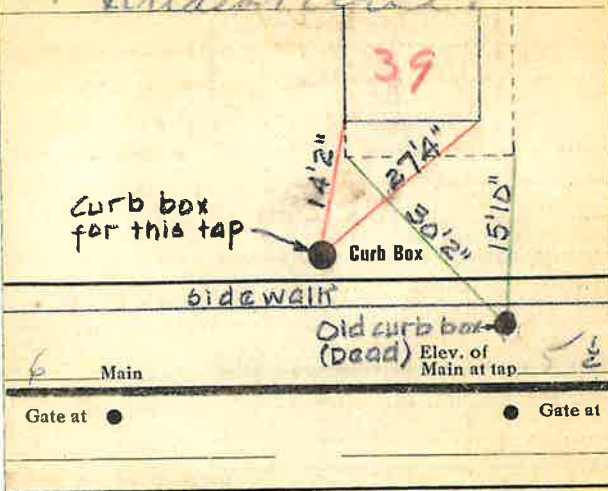

● Curb Box

Old Tap to be dug up.
Shut off at Curb
9-18-73

39 Hudson Ave.

Property

14' 6"

136'

O Tele pole

New tap
inside fence

old tap

29' 6" S.E.

Hudson Ave