

LABOR AND MATERIALS

1	Copper Lead	Connection	3/4		\$ 2.87
1	Curb Valve	T. S. & V.	3/4 in.		\$ 3.62
	Service box	Short 3 1/4 X 4 1/2			
	Old returned	Long 4 1/2 X 5 1/2			
		Buff or Rdway			\$ 4.68
66	Ft. 3/4 in.	Copper Pipe at	32		\$ 21.12
		G. I.			
		C. I.			
	Nipples	in. at			\$
	Bushings	to in. at			\$
	Red'g				
	Inc'g	Coupl'gs to in. at			\$
	Union	in. at			\$
	Meter	in. at			\$
	Lead Joints at				\$
	Compound Joints at				\$
1	Hrs. Water Maint. Man-1	at	1.12		\$ 1.12
16	Hrs. Water Maint. Man-2	at	1.02		\$ 16.32
31	Hrs. Labor-	at	.91		\$ 28.21
	Hrs. Labor-	at			\$
	Hrs. Compressor at				\$
	Compensation Ins. at \$ 2.18	per C			\$ 1.00
	Trucking				\$ 2.00
	Pav't Patch				\$
					\$
					\$
	O'head				\$

This tap is on end of water main and in sewer ditch

\$ 80.94

147

St.
Pt.
Ave. No. 152

Hunley

Name of Owner

Ball

Labor and Mat'l. Report Dec 9 1941

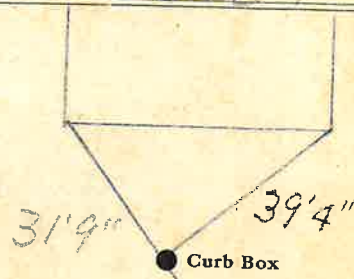

6 Main Elev. of Main at tap 9

Gate at ● ● Gate at

● Curb Box