

Labor and Materials

1	Copper	} Connection ^{3/4"}	\$ 1.75		
1	Lead					
1	Curb	{ Cock Valve T.S.&V. } ^{3/4"} in	\$ 1.70		
1	Service Box					
1	Old returned	{ Short 3 1/2 x 4 1/2 Long 4 1/2 x 5 1/2 Buff. or Railway }	\$ 1.45		
17	Ft. 3/4"	} in { Copper Galv. Iron Cast Iron } Pipe at 13.12 v.s. 2.30			
	Nipples		in. at	\$	
	Bushings	to	in. at	\$	
	Red'g Inc'g	} Couplings	to	in. at	\$
	Union		in. at	\$	
	Meter	in. at	\$		
	Lbs. Br. Stone	at	\$		
	Lbs. Sand	at	\$		
	Bags Cement	at	\$		
	Paving Brick	{ Mack Red Asphalt }	at	\$	
	Lead Joints		at	\$	
	Leadite Joints	at	\$		
6	Hrs. Foreman	at	^{6.25}	\$ 3.75		
3	Hrs. Common Labor	at	⁵⁰	\$ 1.50		
9	Hrs. Common Labor	at	⁴⁵	\$ 4.05		
	Hrs. Mason	at	\$		
	Hrs. Masons Helper	at	\$		
	Hrs. Compressor	at	\$		
	Compensation Ins	\$.75		
	Trucking	\$ 1.-		
	Builders Use of Water	\$		

Total \$ 17.35

1935-37

3/4 tap at 14 Hunter st

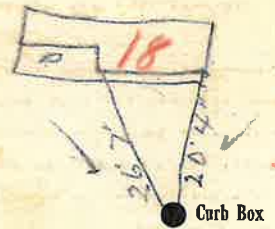

See Below

4" Main Elev of Main at tap 4 1/2

Gate at TAX ID # 302.16-13-32 Gate at

Old tap shift off at main

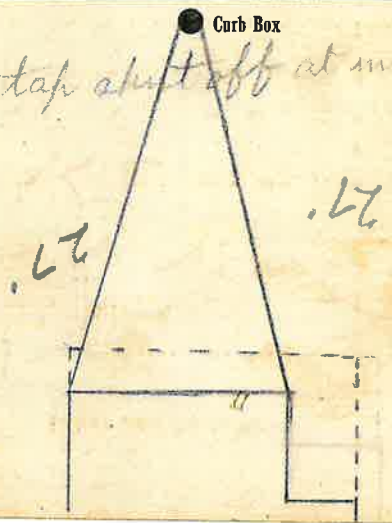

Labor and Materials

1	Copper	Connection $\frac{3}{4}$ "	\$
1	Lead		\$
1	Curb	Cock Valve T.S.&V. $\frac{3}{4}$ " in	\$
1	Service Box		Short $3\frac{1}{2} \times 4\frac{1}{2}$
	Old returned	Long $4\frac{1}{2} \times 5\frac{1}{2}$	\$
		Ball or Rdway	\$
17. Ft.	$\frac{3}{4}$ " in.	Copper Galv. Iron Cast Iron	Pipe at \$
			Nipples in. at \$
		Bushings to in. at \$	
	Red'g Inc'g	Couplings to in. at \$	\$
			\$
	Union	in. at \$	
	Meter	in. at \$	
	Lbs. Br. Stone	at \$	
	Lbs. Sand	at \$	
	Bags Cement	at \$	
	Paving Brick	Mack Red Asphalt	at \$
	Lead Joints		at \$
	Leadite Joints	at \$	
	Hrs. Foreman	at \$	
	Hrs. Common Labor	at \$	
	Hrs. Common Labor	at \$	
	Hrs. Mason	at \$	
	Hrs. Masons Helper	at \$	
	Hrs. Compressor	at \$	
	Compensation Ins	\$	
	Trucking	\$	
	Builders Use of Water	\$	
	Total	\$	

Labor and Material Report

Aug 29

1935

$\frac{3}{4}$ " tap at 14 Meter St.

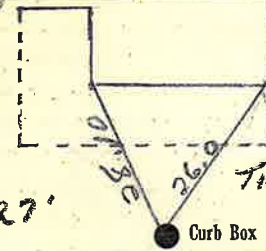

4" Main

Elev of Main at tap $4\frac{1}{2}$

Gate at ●

● Gate at

● Curb Box