

Labor and Materials

1	Copper	} Connection ^{3/4}	\$1.25
1	Lead		
1	Curb	} Cock Valve T.S.&V. } ^{3/4} in	\$1.70
1	Service Box		
	Old returned	} Short 3 1/2 x 4 1/2 } Long 4 1/2 x 5 1/2 } Buff. or Rdwer }	\$1.37
1/2	Ft. 3/4 in.		
		} Copper Galv. Iron } Pipe at 13 1/2	\$1.49
	Nipples	in. at	
1	Bushings	^{3/4} to ^{1/2} in. at	\$.05
	Red'g Inc'g	} Couplings.....to.....in.at	\$
	Union.....in. at		
	Meter.....in. at		\$
	Lbs. Br. Stone at		\$
	Lbs. Sand at		\$
	Bags Cement at		\$
	Paving Brick	} Mack Red Asphalt } at	\$
	Lead Joints at		
	Leadite Joints at		\$
5	Hrs. Foreman at	6 7/8	\$ 3.13
1	Hrs. Common Labor at		\$.50
5	Hrs. Common Labor at	45	\$ 2.25
	Hrs. Mason at		\$
	Hrs. Masons Helper at		\$
	Hrs. Compressor at		\$
	Compensation Ins		\$ 2.22
	Trucking		\$ 1.-
	Builders Use of Water		\$
Total \$			12.96

1935-SI

39

Labor and Material Report Apr 19

1931

3/4 tap at 3 3/2 Hunter st

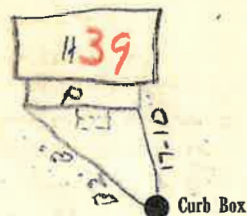

4" Main

Elev. of Main at tap 4 1/2

Gate at ●

● Gate at

● Curb Box

old shut off

TAX ID # 302.16-15-4

HA