

Labor and Materials

1	Copper } Connection	3	\$ 320
1	Curb } Cock Valve } T.S. & V. }	3/4 in.	\$ 100
1	Service Box } Short 3 1/2 x 4 1/2 } Old returned } Long 4 x 6 } Buff or Railway }		\$ 130
22	Ft. } 3/4 in. } Copper } Galv. Iron } Cast Iron }		\$ 484
	Nipples	4 in. at	\$
	Bushings	to in. at	\$
	Red'g } Inc'g } Couplings	to in. at	\$
	Union	in. at	\$
	Meter	in. at	\$
	Lbs Br. Stone at		\$
	Lbs Sand at		\$
	Bags Cement at		\$
	Paving Brick } Mack } Red } Asphalt }	at	\$
	Lead Joints at		\$
	Leadite Joints at		\$
3	Hrs. Foreman at	62 1/2	\$ 187
18	Hrs. Common Labor at	730	\$ 730
	Hrs. Common Labor at		\$
	Hrs. Mason at		\$
	Hrs. Mason's Helper at		\$
	Hrs. Compressor at		\$
	Compensation Ins.	24	\$ 24
1	Trucking	150	\$ 150
	Builders' Use of Water		\$
	Total	2075	\$ 2075

27-104

50

Labor and Material Report

June 22 1927

44 Hydrants 1st

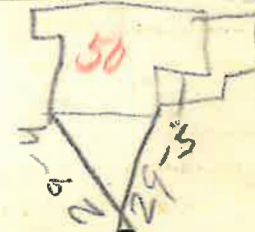

Curb Box

6 Main

Elev. of Main at tap 58

Gate at ●

● Gate at

TAX ID # 302.16-14-24

● Curb Box

old tap dist. connected