

Labor and Materials

1/2	Copper } Connection ^{3/4}	\$ 1.25
1/2	Lead } Connection ^{3/4}	\$ 1.25
1	Curb { Cock Valve T.S.&V. } ^{3/4} in	\$ 1.70
1	Service Box { Short 3 1/2 x 4 1/2 Long 4 1/2 x 5 1/2 } Old returned { Buff. or Rdway }	\$ 1.37
17 Ft.	^{3/4} in. { Copper Galv. Iron } Pipe at 13 1/2 ft.	\$ 2.30
	Nipples in. at	\$
1	Bushings ^{3/8} to ^{1/2} in. at	\$.05
	Red'g Inc'g } Couplings to in. at	\$
	Union in. at	\$
	Meter in. at	\$
	Lbs. Br. Stone at	\$
	Lbs. Sand at	\$
	Bags Cement at	\$
	Paving Brick { Mack Red Asphalt } at	\$
	Lead Joints at	\$
	Leadite Joints at	\$
6	Hrs. Foreman at ^{62.17}	\$ 3.75
2	Hrs. Common Labor at ⁵⁰	\$ 1.00
9	Hrs. Common Labor at ⁴⁵	\$ 4.05
	Hrs. Mason at	\$
	Hrs. Masons Helper at	\$
	Hrs. Compressor at	\$
	Compensation Ins ²⁹	\$ 1.00
	Trucking	\$
	Builders Use of Water	\$
Total		\$ 16.76

1935-33

Labor and Material Report ⁸ Apr 11

1935

3/4 tap at 4 Hunter

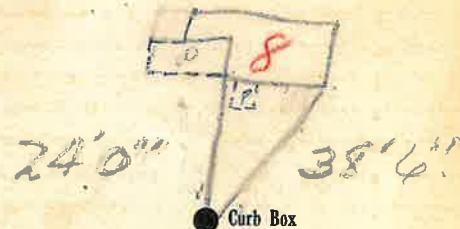

4" Main

Elev. of Main at tap ^{4 1/2}

Gate at ●

● Gate at

● Curb Box

Old tap shut off at main

C.K.

[Signature]