

## LABOR AND MATERIALS

1	Copper Lead	} Connection	3/4		\$ 1.35
1	Curb	{ Cock Valve T. S. & V.	3/4 in.		\$ 1.80
1	Service Box Old - returned	{ Short 3 1/2 x 4 1/2 Long 4 1/2 x 6 1/2 Buff for Rdway			\$ 1.70
24	Ft.	3/4 in.	{ Copper Galv Iron Cast Iron	} Pipe at 18	\$ 4.32
	Nipples	in. at			\$
	Bushings	to	in. at		\$
	Red'g Inc'g	{ Couplings	to	in. at	\$
	Union	in. at			\$
	Meter	in. at			\$
	Lead Joints	at			\$
	Leadite Joints	at			\$
	Hrs. Foreman	at			\$
2	Hrs. Chauffeur	at	.62 1/2		\$ 1.25
4	Hrs. Tapper	at			\$ 2.50
4	Hrs. Labor	at	.45		\$ 1.80
	Hrs. Labor	at			\$
	Hrs. Compressor	at			\$
	Compensation Ins.				\$
	Trucking				\$ .17
	Builders Use of Water	1/2 Patch (Sewer)			\$ 2.50
	<i>Taply Hessel</i>				\$
					\$
					\$
					\$
					\$
					\$ 18.39

6 1941

St. 134  
Pl.  
Ave. No. 120

Hunter St

Name of Owner

O.T. Griffin

Labor and Mat'l. Report

April 8 1941

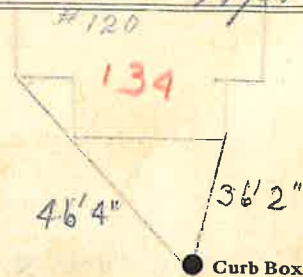

6 Main

Elev. of  
Main at top 4 1/2

Gate at ●

● Gate at

● Curb Box