

LABOR AND MATERIALS

1	Copper	Connection	3/4"	\$
1	Lead	Cock	3/4" Oriseal	\$
1	Curb	Valve	3/4" in.	\$
		T.C. & V.		
1	Service box	Short 3 1/2 x 4 1/2		\$
	Old returned	Long 4 1/2 x 5 1/2		\$
		Buff or Rdway		\$
12	Ft. 3/4 in.	Copper	Pipe at	\$
		C.I.		\$
		C.I.		\$
	Nipples	in. at		\$
	Bushings	to in. at		\$
	Red'g			\$
	Inc'g	Coupl'gs. to in. at		\$
	Union	in. at		\$
	Meter	in. at		\$
	Lead Joints	at		\$
	Compound Joints	at		\$
	Maintenance Foreman			\$
	Hrs. Water Maint. Man-1	at		\$
	Hrs. Water Maint. Man-2	at		\$
	Hrs. Garage Foreman	at		\$
	Hrs. Labor	at		\$
	Hrs. Compressor	at		\$
	Compensation Ins. at \$	per C		\$
	Trucking			\$
	Pav't Patch			\$
	Tap by Gifford & Co.			\$
				\$
		4-24-64.		\$
	O'head			\$
				\$

Jackson

St. Pl. Ave. No. 5

Name of Owner
Raymond Selleck

Labor and Mat'l. Report
Apr. 24 1964

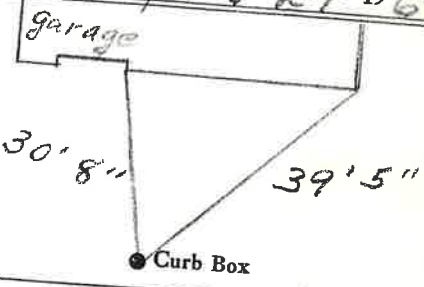

12" C.I. Main
Elev. of Main at tap 5'

Gate at ● Gate at ●
● Curb Box