

LABOR AND MATERIALS

1 Copper } Connection 3/4" \$ _____
 1 Lead }
 1 Curb } Cock } 3/4" in. \$ _____
 } Valve }
 } T.S. & V. }
 1 Service box { Short 3 1/2 x 4 1/2 }
 Old returned { Long 4 1/2 x 5 1/2 }
 { Buff or Rdway } \$ _____
 11 Ft. 3/4" { Copper } Pipe at \$ _____
 { G.I. }
 { C.I. }
 Nipples _____ in. at \$ _____
 Bushings _____ to _____ in. at \$ _____
 Red'g }
 Inc'g } Coupl'gs _____ to _____ in. at \$ _____
 Union _____ in. at \$ _____
 Meter _____ in. at \$ _____
 Lead Joints at \$ _____
 Compound Joints at \$ _____
 Maintenance Foreman \$ _____
 Hrs. Water Maint. Man—1 at \$ _____
 Hrs. Water Maint. Man—2 at \$ _____
 Hrs. Garage Foreman _____ at \$ _____
 Hrs. Labor— _____ at \$ _____
 Hrs. Compressor at \$ _____
 Compensation Ins. at \$ _____ per C \$ _____
 Trucking \$ _____
 Pav't Patch \$ _____
Tap by GIFFORD \$ _____
+ Co. 10-8-62 \$ _____
 O'head \$ _____
 \$ _____

John _____ St. _____
 Ave. No. 12

Name of Owner Wethli.

Labor and Mat'l. Report Oct. 8 19 62

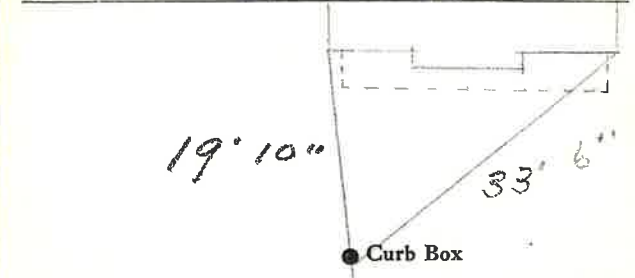

6\" C.I. Main Elev. of Main at tap 5 1/2'

Gate at • Gate at

• Curb Box