

778

Labor and Materials

Copper } Connection.....	?	\$ 1.48
Lead }		
Curb { Cock Valve }	?	\$ 1.79
{ T.S.&V. }		
Service Box { Short 3 1/2 x 4 1/2 }		\$ 1.46
Old returned { Long 4 1/2 x 5 1/2 }		
{ Short or Rdway }		
2.8 Ft. in. { Copper Galv. Iron } Pipe at	3	\$ 5.04
{ Cast Iron }	4	
Nipples		\$
Bushings		\$
Red'g } Couplings		\$
Inc'g }		
Union		\$
Meter		\$
Lbs. Br. Stone at		\$
Lbs. Sand at		\$
Bags Cement at		\$
Paving Brick { Mack Red Asphalt } at		\$
Lead Joints at		\$
Leadite Joints at		\$
11 Hrs. Foreman at		\$ 6.88
9 Hrs. Common Labor at		\$ 3.15
Hrs. Common Labor at		\$
Hrs. Mason at		\$
Hrs. Masons Helper at		\$
Hrs. Compressor at		\$
Compensation Ins		\$ 31
Trucking		\$ 1
Builders Use of Water Patch		\$ 5
Total \$		26.11

5 32-78 16 Labor and Material Report July 2 1932

12 John St

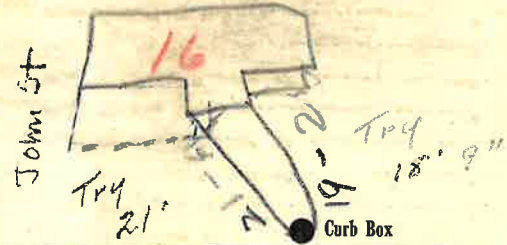

6 Main Standard Elev. of Main at tap 52

Gate at ● Gate at ●

● Curb Box

OK (signature)