

LABOR AND MATERIALS

Copper	} Connection		\$
Lead			
Curb	} Cock Valve	} in.	\$
Service box	} Short 3½ x 4½	}	\$
Ft. 1	} Copper	} Pipe at	\$
in.			
Nipples	in. at		\$
Bushings	to in. at		\$
Red'g	} Coupl'gs	to in. at	\$
Inc'g			
Union	in. at		\$
Meter	in. at		\$
Compound Joints	at		\$
Maintenance Foreman			\$
Hrs. Water Maint. Man-1	at		\$
Hrs. Water Maint. Man-2	at		\$
Hrs. Garage Foreman	at		\$
Hrs. Labor	at		\$
Hrs. Compressor	at		\$
Trucking			\$
Pav't Patch			\$
			\$
			\$
			\$
			\$

St. PL
~~PL~~
 Ave. No. 9

Name of Owner
KATHERINE EAST END ENTR. - 4 APTS.

Labor and Mat'l. Report 1989

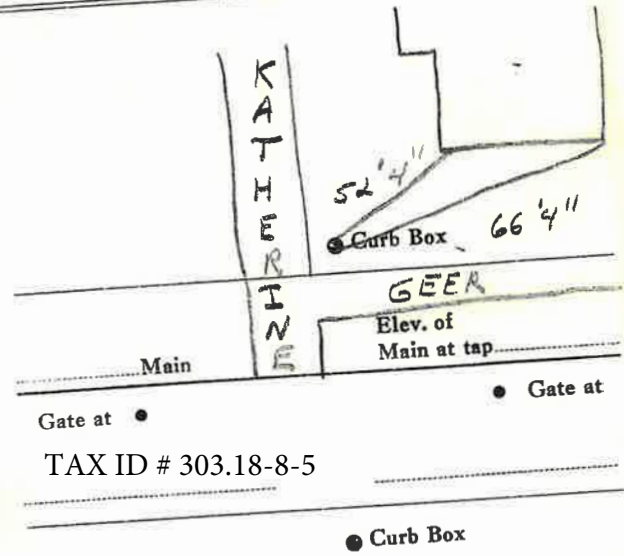

Gate at ●
 TAX ID # 303.18-8-5
 ● Gate at
 ● Curb Box