

LABOR AND MATERIALS

1	Copper	Connection	3/4"	\$	
1	Lead	Cock	3/4 in.	\$	
1	Curb	Valve		\$	
		T.G. & V.		\$	
1	Service box	Short 3 1/2 x 4 1/2		\$	
	Old returned	Long 4 1/2 x 5 1/2		\$	
		Buff or Rdway		\$	
6	Ft. 3/4 in.	Copper	Pipe at	\$	
		C.I.		\$	
		C.I.		\$	
	Nipples	in. at		\$	
	Bushings	to in. at		\$	
	Red'g			\$	
	Inc'g	Coupl'gs to in. at		\$	
	Union	in. at		\$	
	Meter	in. at		\$	
	Lead Joints at			\$	
	Compound Joints at			\$	
	Maintenance Foreman			\$	
	Hrs. Water Maint. Man-1 at			\$	
	Hrs. Water Maint. Man-2 at			\$	
	Hrs. Garage Foreman at			\$	
	Hrs. Labor at			\$	
	Hrs. Compressor at			\$	
	Compensation Ins. at \$	per C		\$	
	Trucking			\$	
	Pay't Patch			\$	
	Tap by Kelly + Peterson			\$	
	12-16-63			\$	
	O'head			\$	

Rd.  
-St-  
-Pl-  
Ave. No. 42

Kensington  
Name of Owner Ernest Sullivan

Labor and Mat'l. Report Dec. 16 1963

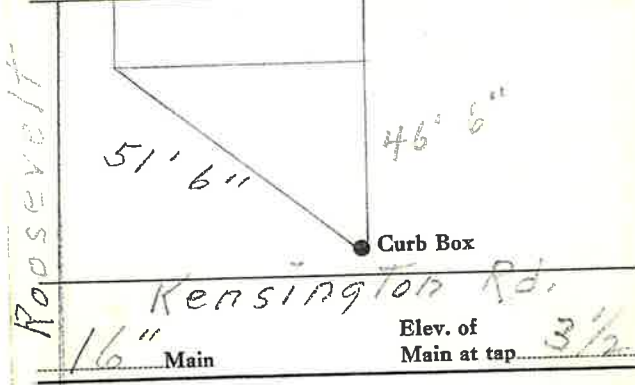

Gate at ● Gate at

● Curb Box

This Tap is Kensington Rd.