

LABOR AND MATERIALS

1	Copper	} Connection $\frac{3}{4}$ "	\$
1	Lead		\$
1	Curb	} $\frac{3}{4}$ in.	\$
	Cock		\$
	Valve		\$
1	Service box	} { Short $3\frac{1}{2}$ x $4\frac{1}{2}$ Long $4\frac{1}{2}$ x $5\frac{1}{2}$ Buff or Rdway	\$
	Old returned		\$
11	Ft. $\frac{3}{4}$ in.		} { Copper G.I. G.I. } Pipe at
	Nipples	in. at \$	
	Bushings	to in. at \$	
	Red'g	} Coupl'gs to in. at	\$
	Inc'g		\$
	Union	in. at \$	
	Meter	in. at \$	
	Lead Joints	at \$	
	Compound Joints	at \$	
	Maintenance Foreman	\$	
	Hrs. Water Maint. Man-1	at \$	
	Hrs. Water Maint. Man-2	at \$	
	Hrs. Garage Foreman	at \$	
	Hrs. Labor	at \$	
	Hrs. Compressor	at \$	
	Compensation Ins. at \$	per C \$	
	Trucking	\$	
	Pav't Patch	\$	
	Tap Made in 1927	\$	
	O'head	\$	

St. 7
Pt. 3
Ave. No. 3

Name of Owner Keitzworthy

Re-
Measured in Nov. 1927

Labor and Mat'l. Report 1927

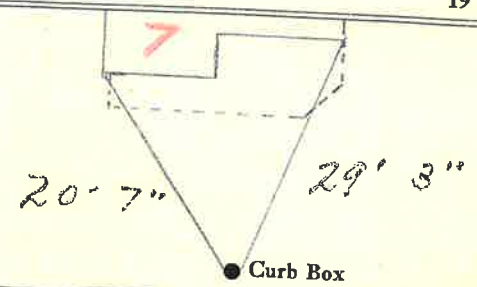

4" Main Elev. of Main at tap 5'

Gate at ● Gate at ●

● Curb Box