

**Labor and Materials**

Lead Connection <sup>3/4</sup>	\$
Curb Cock	\$
1 Service Box (Short 3' x 4')	\$
Old returned	\$
30 Ft. 3/4 in. G. I. Pipe at	\$
1 Nipples 3/4 in. at	\$
Bushings to in. at	\$
1 Red'g Coup 1" to 3/4 in. at	\$
Inc'g Coup to in. at	\$
Union in. at	\$
Meter in. at	\$
Cu. Yds. Br. Stone at	\$
Cu. Yds. Sand at	\$
Bags Cement at	\$
Paving Brick { Mack Red Asphalt } at	\$
2 3/4 Hrs. Foreman at	\$
1 1/4 Hrs. Common Labor at	\$
Hrs. Mason at	\$
1 Hrs. <u>Back</u> at	\$
Hrs. at	\$
7.5 Builders' Use of Water	\$
<u>Track</u> at	\$
at	\$
at	\$
at	\$
Total	\$22.37

**Labor and Material Report**

Aug. 1925

5 \* Knight St.

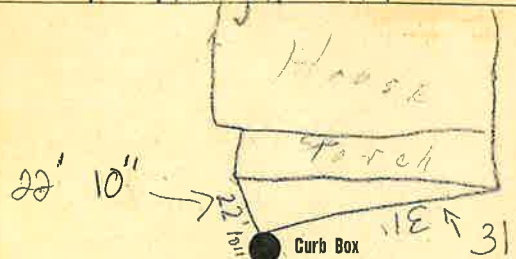

Main

Elev. of Main at tap

Gate at ●

● Gate at

Curb Box

