

LABOR AND MATERIALS

1	Copper Lead	Connection	3/4	\$	2.87
1	Curb	Cock Valve T. S. & V.	3/4 in.	\$	3.62
Service box Old returned		Short 3 1/2 X 4 1/2 Long 4 1/2 X 5 1/2 Buff or Rdway	Same	\$	_____
9	Ft.	3/4 in.	Copper G.I. C.I. } Pipe at	\$	32 2.88
Nipples..... in. at..... \$					
Bushings..... to..... in. at..... \$					
Red'g					
Inc'g Coupl'gs..... to..... in. at..... \$					
Union..... in. at..... \$					
Meter..... in. at..... \$					
Lead Joints at..... \$					
Compound Joints at..... \$					
3	Hrs. Water Maint. Man-1 at		1.12	\$	3.36
5	Hrs. Water Maint. Man-2 at		1.02	\$	5.10
18	Hrs. Labor-..... at		.91	\$	16.38
Hrs. Labor-..... at..... \$					
Hrs. Compressor at..... \$					
Compensation Ins. at		\$ 1.18	per C	\$.54
Trucking		\$ 2.00			
Pav't Patch		\$			
Tape by M. J. Miller		\$			
O'head		\$			
					\$ 36.75

47

St.
-Rl.
Ave. No. 45

LaRose
Name of Owner
Lawrence Howell

Labor and Mat'l. Report Apr 18 1929

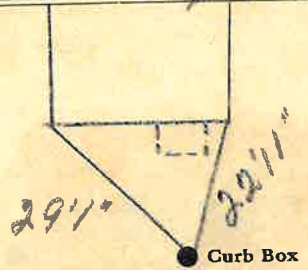

6 Main

Elev. of Main at tap 7

Gate at ● Gate at ●

● Curb Box