

LABOR AND MATERIALS

1	Copper	} Connection	3/4"	\$	2.71
1	Lead				
1	Curb	} Cock Valve T-S. & V.	3/4 in.	\$	3.83
1	Service box				
	Old returned				
					4.69
35	Ft. 3/4 in.	} Copper G.I. G.I.	Pipe at	\$	15.75
	Nipples	in. at		\$	
	Bushings	to in. at		\$	
	Red'g	} Coupl'gs.	to in. at	\$	
	Inc'g				
	Union	in. at		\$	
	Meter	in. at		\$	
	Lead Joints at			\$	
	Compound Joints at			\$	
4	Maintenance Foreman		1.51	\$	6.04
	Hrs. Water Maint. Man-1	at		\$	
8	Hrs. Water Maint. Man-2	at	1.24	\$	9.92
	Hrs. Garage Foreman	at		\$	
20	Hrs. Labor	at	1.13	\$	21.40
	Hrs. Compressor at			\$	
	Compensation Ins. at	\$5.686 per C		\$	2.12
	Trucking			\$	1.50
	Pav't Patch			\$	15.75
Tap by Gifford 12-14-55					
	O'head			\$	
				\$	
				\$	
				\$	83.71

Lake

St.  
Pl.  
Ave. No. 7

Name of Owner

Scioli

Labor and Mat'l. Report

Dec. 14 19 55

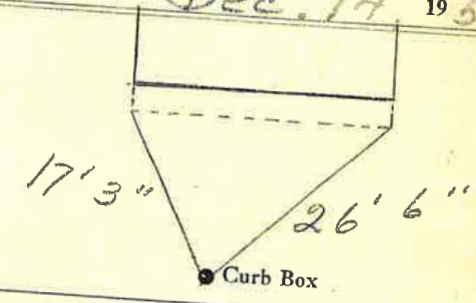

6" Main

Elev. of Main at tap 5 1/2

Gate at •

• Gate at

TAX ID # 302.15-2-7

• Curb Box