

LABOR AND MATERIALS

1	Copper	Connection	3/4	\$
1	Lead	Cook		\$
1	Curb	Valve	3/4 in.	\$
		T.S. & V.		\$
1	Service box	Short 3 1/2 x 4 1/2		\$
	Old returned	Long 4 1/2 x 5 1/2		\$
		Buff or Rdway		\$
7	Ft.	Copper		\$
	3/4 in.	G.I.		\$
		G.I.		\$
		Pipe at		\$
	Nipples	in. at	Brass	\$
1	Bushings	3/4 to 1/2 in. at		\$
	Red'g			\$
	Inc'g	Coupl'gs. to in. at		\$
	Union	in. at		\$
	Meter	in. at		\$
	Lead Joints at			\$
	Compound Joints at			\$
	Maintenance Foreman			\$
	Hrs. Water Maint. Man-1 at			\$
	Hrs. Water Maint. Man-2 at			\$
	Hrs. Garage Foreman at			\$
	Hrs. Labor at			\$
	Hrs. Compressor at			\$
	Compensation Ins. at \$	per C		\$
	Trucking			\$
	Pav't Patch			\$
	Tap by Gifford & Co.			\$
		5-7-57		\$
	O'head			\$
				\$

St. Lawrence Ave. No. 46

Name of Owner Lineham

Labor and Mat'l. Report May 2 1957

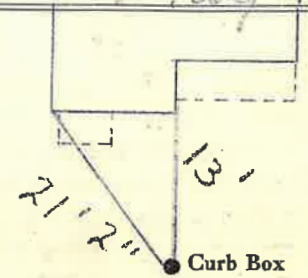

12" Main Elev. of Main at tap 4 1/2'

Gate at • Gate at

TAX ID # 303.17-2-25

• Curb Box