

### Labor and Materials

|       |                        |                           |             |       |           |
|-------|------------------------|---------------------------|-------------|-------|-----------|
| 1     | Copper                 | Connection                | 3           |       | \$ 3.20   |
|       | Lead                   |                           |             |       |           |
| 1     | Curb                   | Cock Valve T.S. & V.      | 3           | in.   | \$ 1.00   |
| 1     | Service Box            | Short 3 1/2 x 4 1/2       |             |       | \$ 1.30   |
|       | Old returned           | Long 4 x 5 1/2            |             |       |           |
|       |                        | Bull. or Rdway            |             |       |           |
| 9     | Ft.                    | Copper Galv. Iron Pipe at | 3           | 2 1/2 | \$ 19.8   |
|       |                        | Cast Iron                 |             |       |           |
|       | Nipples                | in. at                    |             |       | \$        |
|       | Bushings               | 3/4 to 1/2 in. at         |             |       | \$ .08    |
|       | Red'g Inc'g            | Couplings                 | 2           | to    | \$ 1.5    |
|       | Union                  | in. at                    | 1/4         |       | \$        |
|       | Meter                  | in. at                    |             |       | \$        |
|       | Lbs. Br. Stone         | at                        |             |       | \$        |
|       | Lbs. Sand              | at                        |             |       | \$        |
|       | Bags Cement            | at                        |             |       | \$        |
|       | Paving Brick           | Mack Red Asphalt          |             | at    | \$        |
|       | Lead Joints            | at                        |             |       | \$        |
|       | Leadite Joints         | at                        |             |       | \$        |
| 1     | Hrs. Foremar           | at                        | Person 62.5 |       | \$ 1.62   |
| 7     | Hrs. Common Labor      | at                        | 40.8        |       | \$ 2.85   |
|       | Hrs. Common Labor      | at                        |             |       | \$        |
|       | Hrs. Mason             | at                        |             |       | \$        |
|       | Hrs. Mason's Helper    | at                        |             |       | \$        |
|       | Hrs. Compressor        | at                        |             |       | \$        |
|       | Compensation Ins.      |                           |             |       | \$ 10     |
|       | Trucking               |                           |             |       | \$ 100    |
|       | Builders' Use of Water |                           |             |       | \$        |
| Total |                        |                           |             |       | \$ 121.78 |

26-46 50

Labor and Material Report

19

44 Lawrence St.  
~~44 Walnut St.~~

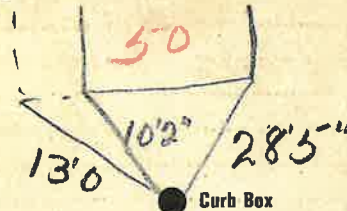

Main

Elev. of Main at tap

Gate at

Gate at

18.11.11.11.11.11

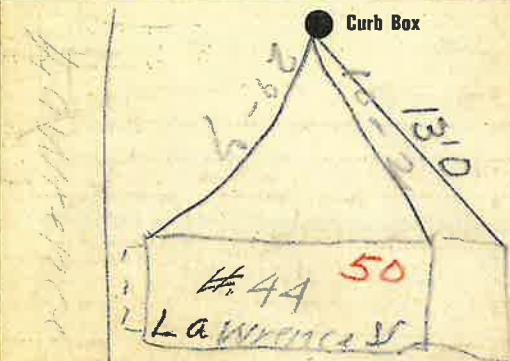

Lawrence St.

26-46 50

Labor and Material Report

3 June 26 1926

44 LAWRENCE ST.  
~~44 WALNUT ST.~~

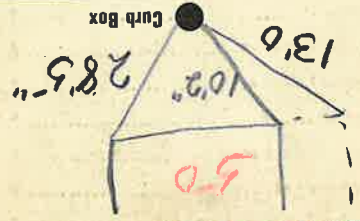

Main 2  
Elev. of Main at tap 46

Gate at ● Gate at ●

18 MILLIN ST

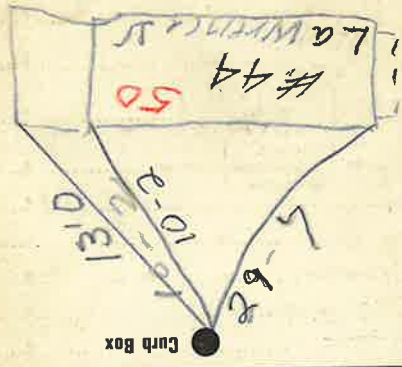

LAWRENCE ST