

LABOR AND MATERIALS

1	Copper Lead	Connection	3/4"	\$ 2.41
1	Curb	Cock Valve T.S. & V.	3/4 in.	\$ 3.41
1	Service box Old returned	Short 3 1/2 x 4 1/2 Long 4 1/2 x 5 1/2 Buff or Rdway		\$ 4.18
27	3/4 in.	Copper Pipe at	40	\$ 10.80
		<del>G.I.</del> <del>C.I.</del>		
	Nipples	in. at		\$
	Bushings	to in. at		\$
	Red'g Inc'g	Coupl'gs to in. at		\$
	Union	in. at		\$
	Meter	in. at		\$
	Lead Joints	at		\$
	Compound Joints	at		\$
	Maintenance Foreman			\$
	Hrs. Water Maint. Man-1	at		\$
10	Hrs. Water Maint. Man-2	at 124		\$ 13.40
	Hrs. Garage Foreman	at		\$
22	Hrs. Labor	at 113		\$ 24.86
	Hrs. Compressor	at		\$
	Compensation Ins. at \$ 3.861 per C			\$ 1.44
	Trucking			\$ 1.50
	Pav't Patch			\$
	Tap by 9155010-28-54			\$
	Pipe renewed 11-4-54			\$
	after Application was			\$
	O'head Made			\$
	Leak in old 1" galv. Pipe			\$ 6.00

61 03

37 26

St. Lawrence Ave. No. 95

Name of Owner Johnson  
Renewed Pipe Nov. 4-54  
Labor and Mat'l. Report Oct. 28 1954

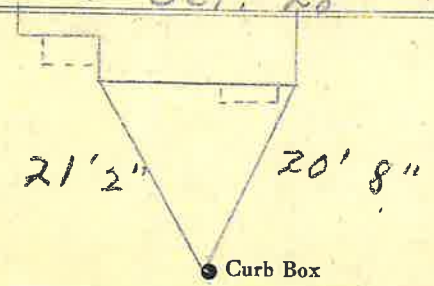

12" Main Elev. of Main at tap 5 1/2"  
Gate at • Gate at •

• Curb Box  
This Tap Changed from 4" to 12" Main  
10-28-54