

### Labor and Materials

1	Copper	Connection	3"	\$ 3.20
1	Curb	Cock Valve	3/4 in.	\$ 1.00
1	Service Box	Short 3 1/2 x 4		
	Old returned	Long 4 1/2 x 5 1/2		
		Buff. or Railway		
7	Ft.	3/4 in.	Copper Pipe at	\$ 1.54
			Cast Iron	
	Nipples	in. at		\$
	Bushings	to in. at		\$
	Red'g Inc'g	Couplings to in. at		\$
	Union	in. at		\$
	Meter	in. at		\$
	Lbs. Br. Stone	at		\$
	Lbs. Sand	at		\$
	Bags Cement	at		\$
	Paving Brick	Mack Red Asphalt at		\$
	Lead Joints	at		\$
	Leadite Joints	at		\$
2	Hrs. Foreman	at		\$ 1.25
4	Hrs. Common Labor	at		\$ 1.63
	Hrs. Common Labor	at		\$
	Hrs. Mason	at		\$
	Hrs. Mason's Helper	at		\$
	Hrs. Compressor	at		\$
	Compensation Ins.	at		\$ 1.08
1	Trucking			\$ 1.00
2.5	Builders' Use of Water			\$
Total \$				9.70

### Labor and Material Report

10  
Mar 18 1925

TAP AT 4 LAWRENCE ST

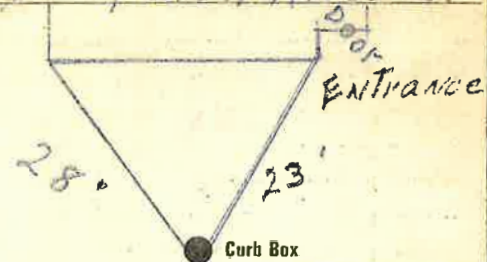

12 Main

Elev. of Main at tap 5

Gate at ●

● Gate at

● Curb Box

TAX ID # 303.17-8-14