

Labor and Materials

1	Copper	} Connection	3/4"	\$					
	Lead									
1	Curb	} Cock Valve	} 3/4"	in	\$				
1	Service Box	} Short 3 1/2 x 4 1/2	}	\$					
7	Old returned					} Long 4 1/2 x 5 1/2	}	\$	
10	Ft. 3/4"	} Buff. or Rdway	}	Pipe at	\$				
							} Copper	}	\$
		} Cast Iron	}	\$					
	Nipples					in. at	\$		
	Bushings	to	in. at	\$					
	Red'g	} Conplings	to	in. at	\$				
	Inc'g									
	Union	in. at	\$						
	Meter	in. at	\$						
	Lead Joints	at	\$						
	Leadite Joints	at	\$						
	Hrs. Foreman	at	\$						
	Hrs. Chauffeur	at	\$						
	Hrs. Tapper	at	\$						
	Hrs. Labor	at	\$						
	Hrs. Labor	at	\$						
	Hrs. Compressor	at	\$						
	Compensation Ins.	\$							
	Trucking	\$							
	Builders Use of Water	\$							
	Tap by Bureau	\$							
	9-14-55	\$							
		\$							
		\$							
		\$							

St. *104*
 Pl. *Laurence*
 Ave. No. *72*

Name of Owner
 Renewal *Sept. 14-1955*
 Labor and Mat'l. Report *Sept. 30 1952*

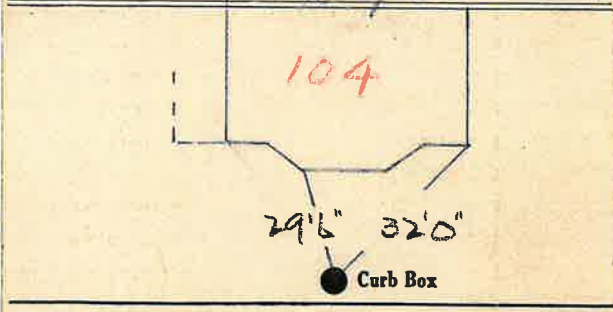

12" Main
 Elev. of Main at tap *4 1/2'*
 Gate at • Gate at

