

Labor and Materials

Copper Lead } Connection <i>2 1/2</i> ft.....	\$3.20
Curb { Cock Valve } <i>2 1/2</i> in.....	\$1.00
T. S. & V. }	
Service Box { Short $3\frac{1}{2} \times 4\frac{1}{2}$ Long $4\frac{1}{2} \times 5\frac{1}{2}$ Buff. or Rdway }	\$1.30
Old returned }	
<i>7</i> Ft. <i>2 1/2</i> in. { Copper Galv. Iron } Pipe at.....	\$3.96
Cast Iron }	
Nipples..... in. at.....	\$
Bushings..... to..... in. at.....	\$
Red'g } Couplings..... to..... in. at.....	\$
Inc'g }	
Union..... in. at.....	\$
Meter..... in. at.....	\$
Lbs. Br. Stone at.....	\$
Lbs. Sand at.....	\$
Bags Cement at.....	\$
Paving Brick { Mack Red } at.....	\$
Asphalt }	
Lead Joints at.....	\$
Leadite Joints at.....	\$
<i>4</i> Hrs. Foreman at..... <i>6 25</i>	\$2.50
<i>6</i> Hrs. Common Labor at..... <i>50</i>	\$3.00
<i>8</i> Hrs. Common Labor at..... <i>40 1/2</i>	\$3.25
Hrs. Mason at.....	\$
Hrs. Mason's Helper at.....	\$
Hrs. Compressor at.....	\$
Compensation Ins.....	\$ 23
Trucking.....	\$1.00
Builders' Use of Water.....	\$

Total \$19.44

27-177 106

Labor and Material Report

Oct 8

19 37

Pro 74 Lawrence st

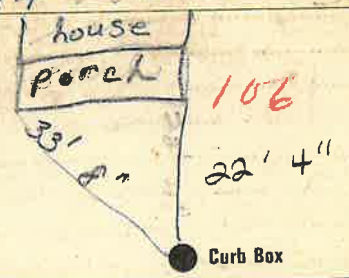

12" changed over 4 1/2'
9-14-55
Main Elev. of Main at tap 6'

Gate at ●

● Gate at

● Curb Box

Old Tap
Shut off