

Labor and Materials

1	Copper	Connection	3	\$ 320
1	Lead		3	\$ 100
1	Curb	Cock Valve T.S. & V.		\$ 140
1	Service Box	Short 3/4"x4 1/2"		
	Old returned	Long 4 1/2"x5 1/2"		
		Patent Railway		
38	Ft.	Copper Pipe at	7/4	\$ 832
		Cast Iron		
	Nipples	in. at		\$
	Bushings	to in. at		\$
	Red'g Inc'g	Couplings to in. at		\$
	Union	in. at		\$
	Meter	in. at		\$
	Lbs. Br. Stone	at		\$
	Lbs. Sand	at		\$
	Bags Cement	at		\$
	Paving Brick	Mack Red Asphalt at		\$
	Lead Joints	at		\$
	Leadite Joints	at		\$
7	Hrs.	Foreman at		\$ 4.38
20	Hrs.	Common Labor at		\$ 21.19
	Hrs.	Common Labor at		\$
	Hrs.	Mason at		\$
	Hrs.	Mason's Helper at		\$
	Hrs.	Compressor at		\$
	Compensation	Ins	44	\$ 1.00
	Trucking			\$
	Builders' Use of Water			\$
Total \$				31.97

28-70

26

Sept 12 1928

Labor and Material Report

12 Leonard St

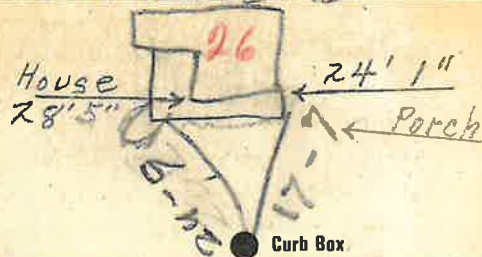

4 Main Elev of Main at tap 6
 Gate at ● Gate at ●

● Curb Box

old Tap & shut off