

LABOR AND MATERIALS

1 Copper } Connection ³/₄ in. \$
~~Lead~~ }
 1 Curb } Cook Valve } ³/₄ in. \$
 } T.S. & V. }
 1 Service box } Short ³/₂ x ⁴/₂ }
 Old returned } Long ⁴/₂ x ⁵/₂ } \$
 } Buff or Rdway }
 11 Ft. ³/₄ in. } Copper } Pipe at \$
 } C.I. }
 } C.I. }
 Nipples in. at \$
 Bushings to in. at \$
 Red'g }
 Inc'g } Coupl'gs to in. at \$
 Union in. at \$
 Meter in. at \$
 Lead Joints at \$
 Compound Joints at \$
 Maintenance Foreman \$
 Hrs. Water Maint. Man-1 at \$
 Hrs. Water Maint. Man-2 at \$
 Hrs. Garage Foreman at \$
 Hrs. Labor at \$
 Hrs. Compressor at \$
 Compensation Ins. at \$ per C. \$
 Trucking \$
 Pav't Patch \$
 Tap by Gifford & Co. \$
 4-24-59 \$
 O'head \$
 \$

✓
 Lexington St. Pl. Ave. No. 32

Name of Owner Paul Dudley

Labor and Mat'l. Report April 24 19 59.

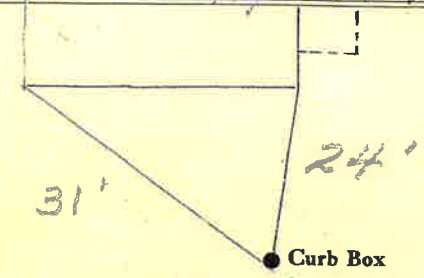

6" Main Elev. of Main at tap 6'

Gate at • Gate at •

• Curb Box