

LABOR AND MATERIALS

1	Copper	Connection	3/4"		\$	
	Lead				\$	
1	Curb	Cook Valve	3/4 in.		\$	
		T.S. & V.			\$	
1	Service box	}	Short 3 1/2 x 4 1/2		\$	
	Old returned		Long 4 1/2 x 5 1/2		\$	
			Buff or Rdway		\$	
9	Ft. 3/4 in.	Copper	}	Pipe at	\$	
		C.I.			\$	
		C.I.			\$	
	Nipples	in. at		\$		
	Bushings	to in. at		\$		
	Red'g	}	Coupl'gs to in. at	\$		
	Inc'g			\$		
	Union	in. at		\$		
	Meter	in. at		\$		
	Lead Joints	at		\$		
	Compound Joints	at		\$		
	Maintenance Foreman			\$		
	Hrs. Water Maint. Man	1 at		\$		
	Hrs. Water Maint. Man	2 at		\$		
	Hrs. Garage Foreman	at		\$		
	Hrs. Labor	at		\$		
	Hrs. Compressor	at		\$		
	Compensation Ins.	at \$ per C		\$		
	Trucking			\$		
	Pav't Patch			\$		
	Tap by Gifford & Co.			\$		
	12-13-67			\$		
	O'head			\$		

St. _____
Pl. _____
Ave. No. 70

Name of Owner
Betty Quist

Labor and Mat'l. Report Dec. 13 1967

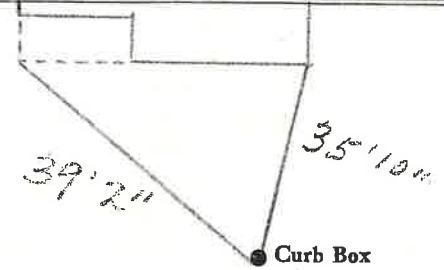

6" Main Elev. of Main at tap 5'

Gate at ● ● Gate at

● Curb Box