

Labor and Materials

| | | | | |
|-----|------------------------|-----------------------|---------|----------|
| 1 | Copper | Connection | 3/4 | \$ 3.20 |
| 1 | Lead | | | |
| 1 | Curb | Cock Valve T. S. & V. | in. | \$ 1.50 |
| 1 | Service Box | Short 3 1/2 x 4 1/2 | | \$ 1.30 |
| | Old returned | Long 4 1/2 x 5 1/2 | | |
| | | Buff. or Rdway | | |
| 4.4 | Ft. | 3/4 in. Copper | Pipe at | \$ 9.68 |
| | | Cast Iron | | |
| | | Cast Lead | | |
| | Nipples | in. at | | \$ |
| | Bushings | to in. at | | \$ |
| | Red'g Inc'g | Couplings to in. at | | \$ |
| | Union | in. at | | \$ |
| | Meter | in. at | | \$ |
| | Lbs. Br. Stone | at | | \$ |
| | Lbs. Sand | at | | \$ |
| | Bags Cement | at | | \$ |
| | Paving Brick | Mack Red Asphalt at | | \$ |
| | Lead Joints | at | | \$ |
| | Leadite Joints | at | | \$ |
| 3 | Hrs. Foreman | at | | \$ 1.87 |
| 16 | Hrs. Common Labor | at | | \$ 6.50 |
| | Hrs. Common Labor | at | | \$ |
| | Hrs. Mason | at | | \$ |
| | Hrs. Mason's Helper | at | | \$ |
| | Hrs. Compressor | at | | \$ 22 |
| | Compensation Ins. | | | \$ 1.57 |
| | Trucking | | | \$ |
| | Builders' Use of Water | | | \$ |
| | Total | | | \$ 24.77 |

77-137

Labor and Material Report Aug 11 1927

3/4 tap at 13 Lincoln Ave.

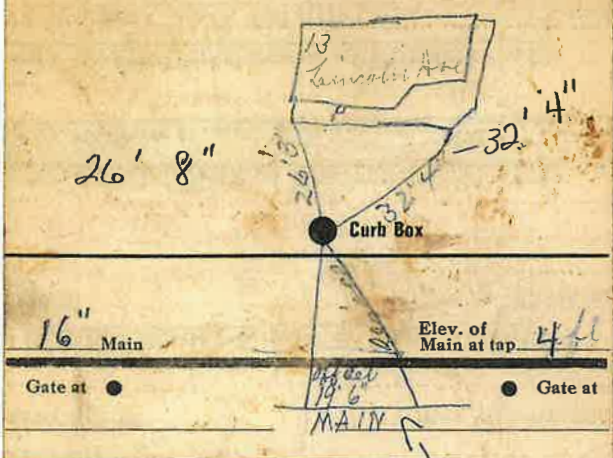

TAX ID # 302.15-12-29