

Labor and Materials

1	Copper } Connection	74	\$ 320
	Lead }		
1	Curb { Cock } { Valve } { T.S. & V. }	31 in.	\$ 100
1	Service Box { Short 3 1/2 x 4 1/2 } Old returned { Long 4 1/2 x 5 1/2 } { Buff. or Rdway }		\$ 120
58	Ft. 7/8 in. { Copper } { Galv. Iron } { Cast Iron }	Pipe at	\$ 536
	Nipples	in. at	\$
1	Bushings	3/4 to 1/2 in. at	\$ 08
1	Red g } Couplings	3/4 Road to in. at	\$ 15
	Inc g }		
	Union	in. at	\$
	Meter	in. at	\$
	Lbs. Br. Stone	at	\$
	Lbs. Sand	at	\$
	Bags Cement	at	\$
	Paving Brick { Mack } { Red } { Asphalt }	at	\$
	Lead Joints	at	\$
	Leadite Joints	at	\$
5	Hrs. Foreman	62.5	\$ 313
1.5	Hrs. Common Labor	50	\$ 75.0
1.4	Hrs. Common Labor	40.8	\$ 29.9
	Hrs. Mason	at	\$
	Hrs. Mason's Helper	at	\$
	Hrs. Compressor	at	\$
	Compensation Ins.	43	\$ 43
	Trucking	100	\$ 100
	Builders' Use of Water		\$
Total			\$ 318.4

26-157

Labor and Material Report

Sept 30

1916

15 Lincoln Ave

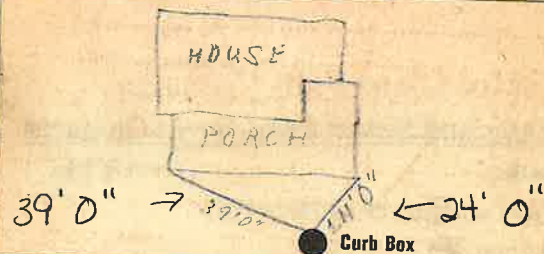

16 Main

Elev. of Main at tap

Gate at

Gate at

Curb Box