

LABOR AND MATERIALS

1 Copper Lead } Connection $\frac{3}{4}$ in. \$ 1.23
 1 Curb { Cock Valve T.S. & V. } $\frac{3}{4}$ in. \$ 1.68
 1 Service Box Old returned { Short $3\frac{1}{2} \times 4\frac{1}{2}$ Long $4\frac{1}{2} \times 5\frac{1}{2}$ Buff. or Rdway } \$ 1.75
 13 Ft. $\frac{3}{4}$ in. { Copper Galv. Iron Cast Iron } Pipe at \$ 1.95
 Nipples in. at \$
 Bushings to in. at \$
 Red'g Inc'g { Couplings to in. at \$
 Union in. at \$
 Meter in. at \$
 Lead Joints at \$
 Leadite Joints at \$
 Hrs. Foreman at \$
 2 Hrs. Chauffeur at $6\frac{1}{2}$ \$ 1.25
 3 Hrs. Tapper at $7\frac{1}{2}$ \$ 1.88
 18 Hrs. Labor at $7\frac{1}{2}$ \$ 8.10
 Hrs. Labor at \$
 1 Hrs. Compressor at $8\frac{1}{2}$ \$ 88
 Compensation Ins. \$ 35
 Trucking \$ 1
 Builders Use of Water no patch (lost) \$
 Tap 1/4 Hecell \$
 \$ 19.07

130 - 1938

St.

Pl.

Ave. No. 42

Name of Owner

H C Mc Murray

Labor and Mat'l. Report

Aug 31

1938

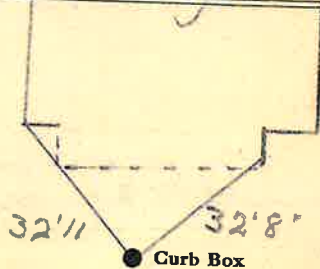

Curb Box

16 Main

Elev. of Main at tap

4

Gate at

Gate at

Curb Box

old shut off