

LABOR AND MATERIALS

1	Copper Lead	Connection	3/4"	\$
1	Curb	Clock Valve T. S. & V.	Oriseal 3/2" in.	\$
	Service box	Short 3 1/2 X 4 1/2		\$
	Old returned	Long 4 1/2 X 5 1/2		\$
		Buff or Rdway		\$
10	Ft.	3/2 in.	Copper Galv. Iron Cast Iron	Pipe at \$
	Nipples	in. at		\$
	Bushings	to in. at		\$
	Red'g Inc'g	Couplings	to in. at	\$
	Union	in. at		\$
	Meter	in. at		\$
	Lead Joints	at		\$
	Compound Joints	at		\$
	Hrs. Foreman	at		\$
	Hrs. Chauffeur	at		\$
	Hrs. Tapper	at		\$
	Hrs. Labor	at		\$
	Hrs. Labor	at		\$
	Hrs. Compressor	at		\$
	Compensation Ins.			\$
	Trucking			\$
	Builders Use of Water			\$
				\$
				\$
				\$
				\$
				\$
				\$

10 Trapped July 13-17  
By G. S. Ford

St. 13  
 Pl. 9  
 Ave. No. 9  
 Locust  
 Name of Owner Hurry Bromley  
 Labor and Mat'l. Report July 13 1967

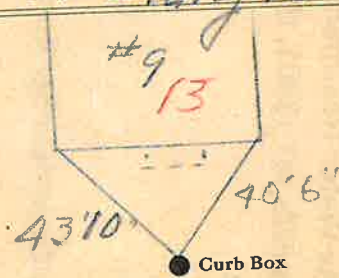

4" Main Elev. of Main at tap 5'  
 Gate at ● Gate at ●

● Curb Box