

LABOR AND MATERIALS

1	Copper	Connection	3/4"	\$
1	Lead	Cock	3/4" in.	\$
1	Curb	Valve		\$
		T. S. & V.		\$
1	Service box	Short 3 1/2 x 4 1/2		\$
	Old returned	Long 4 1/2 x 5 1/2		\$
		Buff. or Rdway		\$
27	Ft. 3/4 in.	Copper	Pipe at	\$
		C.I.		\$
		C.I.		\$
	Nipples	in. at		\$
	Bushings	to in. at		\$
	Red'g			\$
	Inc'g	Coupl'gs to in. at		\$
	Union	in. at		\$
	Meter	in. at		\$
	Lead Joints	at		\$
	Compound Joints	at		\$
	Maintenance Foreman			\$
	Hrs. Water Maint. Man-1	at		\$
	Hrs. Water Maint. Man-2	at		\$
	Hrs. Garage Foreman	at		\$
	Hrs. Labor	at		\$
	Hrs. Compressor	at		\$
	Compensation Ins. at \$	per C		\$
	Trucking			\$
	Pav't Patch			\$
	Tap by Gissard			\$
	& Co.	8-25-60		\$
	O'head			\$
				\$

Dr. McArthur  
 Sr. 33  
 Pl. 33  
 Ave. No. 33

Name of Owner Frank Collins

Labor and Mat'l. Report Aug. 25 1960

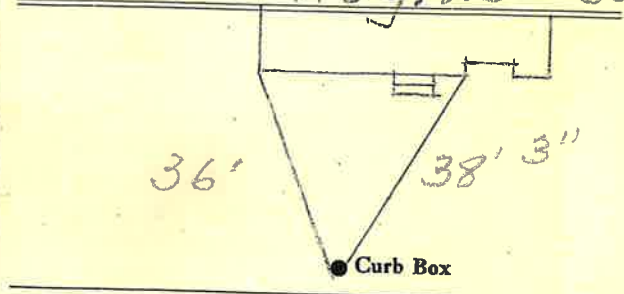

12" Main Elev. of Main at tap 5 1/2"

Gate at ● Gate at ●

● Curb Box