

Labor and Materials

Copper	Connection	3	\$ 1.46
Lead			
Curb	Cock	3	\$ 1.93
	T. S. & V.		
Service Box	Short 3 1/2 x 4 1/2		\$ 1.77
Old returned	Long 4 1/2 x 5 1/2		
	Buff or Rdway		
12 Ft.	Copper	3	\$ 2.64
	Galv. Iron		
	Cast Iron		
Nipples	in. at		\$
Bushings	to in. at		\$
Red'g	Conplings to in. at		\$
Inc'g			\$
Union	in. at		\$
Meter	in. at		\$
Lead Joints	at		\$
Leadite Joints	at		\$
Hrs. Foreman	at		\$
3	Hrs. Chauffeur	6.25	\$ 1.88
Hrs. Tapper	at		\$
13	Hrs. Labor	45	\$ 5.85
Hrs. Labor	at		\$
Hrs. Compressor	at		\$
Compensation Ins.			\$.24
Trucking			\$ 1.00
Builders Use of Water	Patrol 7 (2 men)		\$ 5.00
Tapped Person			

161-1937

St. Pl. Ave. No. 5

Name of Owner Fish & Deppan

Labor and Mat'l. Report Nov 18 1937

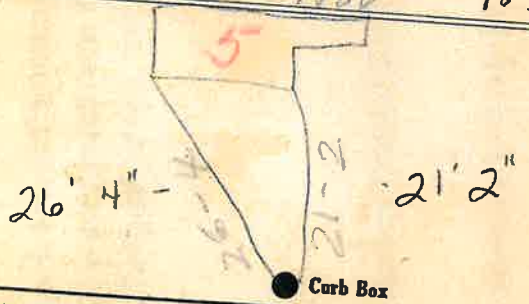

6" Main
 4" Main at tap
 Elev. of Main at tap 4 1/2'

Gate at ● Gate at ●

● Curb Box

old taps disconnected