

Labor and Materials

Copper } Connection ^{3/4"}	\$ 1.48
Lead }	
Curb { Cock Valve T.S. & V. } ^{3/4"} in	\$ 1.79
Service Box { Short 3 1/2 x 4 1/2 }	\$ 1.30
Old returned { Long 4 1/2 x 5 1/2 }	
23 ^{3/4} Ft. ^{3/4} in. { Copper } Pipe at	\$ 2.78
21 ^{3/4} Ft. ^{3/4} in. { Cast Iron }	
Nipples	\$
Bushings	\$
1 Red's } Cop to Cop Couplings	\$
1 Inc's }	\$
Union	\$
Meter	\$
Lbs. Br. Stone at	\$
Lbs. Sand at	\$
Bags Cement at	\$
Paving Brick { Mack Red Asphalt } at	\$
Lead Joints at	\$
Leadite Joints at	\$
5 Hrs. Foreman at	\$ 3.15
12 Hrs. Common Labor at	\$ 5.40
Hrs. Common Labor at	\$
Hrs. Mason at	\$
Hrs. Masons Helper at	\$
Hrs. Compressor at	\$
Compensation Ins	\$ 26
Trucking	\$ 1
Builders Use of Water Patch	\$ 5
Total \$ 23.14	

S 32-133 6
 Labor and Material Report Nov 7 1922

2 Madison St

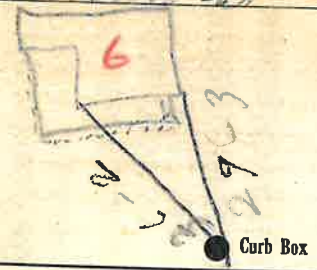

6" Main

Elev. of Main at tap 5'

Gate at ● Gate at ●

● Curb Box

old Tap shut off at Main

OK [Signature]

LABOR AND MATERIALS

Copper } Connection	\$
Lead }	\$
Curb { Clock Valve }	\$
{ T. S. & V. }	\$
Service box } Short 3½X4½ }	\$
Old returned } Long 4½X5½ }	\$
{ Buff for Rdway }	\$
Ft. in. } Copper } Pipe at	\$
{ Galv. Iron }	
{ Cast Iron }	
Nipples	\$
Bushings	\$
Red'g } Couplings	\$
Inc'g } to	\$
Union	\$
Meter	\$
Lead Joints at	\$
Compound Joints at	\$
Hrs. Foreman at	\$
Hrs. Chauffeur at	\$
Hrs. Tapper at	\$
Hrs. Labor at	\$
Hrs. Labor at	\$
Hrs. Compressor at	\$
Compensation Ins.	\$
Trucking	\$
Builders Use of Water	\$
.....	\$
.....	\$
.....	\$
.....	\$
.....	\$
.....	\$
.....	\$

St. 6

Pl. Madison

Ave. No. 2

Name of Owner

Labor and Mat'l. Report Oct 25 1926

Curb Box

Main

Elev. of Main at tap

Gate at ● ● Gate at

Curb Box

LSM-5C-6-1-45