

Labor and Materials

1	Copper } Connection	3/4"	\$ 2.60
	Lead		
1	Curb } Cock Valve	3/4" in.	\$ 2.30
		T. S. & V.	
1	Service Box } Short 3 1/2 x 4 1/2		\$ 1.40
	Old returned } Long 4 1/2 x 5 1/2		
		Buff. or Rdway	
11	Pt. 3/4" in. } Copper		\$ 2.92
		Gals. Iron	
		Cast Iron	
	Nipples	in. at	\$
	Bushings	to in. at	\$
	Red'g } Couplings	to in. at	\$
	Inc'g		
	Union	in. at	\$
	Meter	in. at	\$
	Lbs. Br. Stone	at	\$
	Lbs. Sand	at	\$
	Bags Cement	at	\$
	Paving Brick } Mack		\$
		Red	
		Asphalt	
	Lead Joints	at	\$
	Leadite Joints	at	\$
2	Hrs. Foreman	at	\$ 1.28
16	Hrs. Common Labor	at	\$ 6.50
	Hrs. Common Labor	at	\$
	Hrs. Mason	at	\$
	Hrs. Mason's Helper	at	\$
	Hrs. Compressor	at	\$
	Compensation Ins		\$ 21
	Trucking		\$ 1.00
	Builders' Use of Water	Patch	\$ 5.00
Total \$			23.17

29-45

Labor and Material Report

1929

109
57

Maple St.

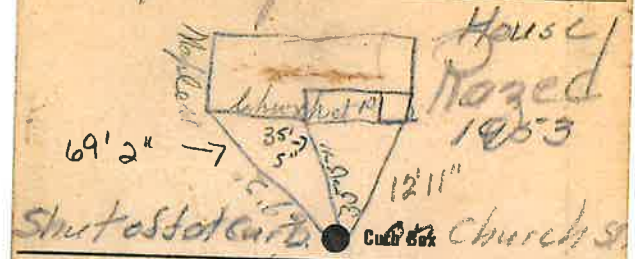

6 Main Eley of Main at tap 4/15
Gate at ● Gate at ●

● Curb Box

This Place Razed
Shut off at Curb

