

LABOR AND MATERIALS

1 Copper } Connection 1" \$
 Lead }
 1 Curb } Cock } 1 in. Ori seal. \$
 Valve }
 T.S. & V. }
 1 Service box } Short 3 1/2 x 4 1/2 }
 Old returned } Long 4 1/2 x 5 1/2 }
 } Buff or Rdway } \$
 30 Ft. 1 in. } Copper } Pipe at \$
 } G.I. }
 } G.I. }
 Nipples in. at \$
 Bushings to in. at \$
 Red'g }
 Inc'g } Coupl'gs to in. at \$
 Union in. at \$
 Meter in. at \$
 Lead Joints at \$
 Compound Joints at \$
 Maintenance Foreman \$
 Hrs. Water Maint. Man-1 at \$
 Hrs. Water Maint. Man-2 at \$
 Hrs. Garage Foreman at \$
 Hrs. Labor at \$
 Hrs. Compressor at \$
 Compensation Ins. at \$ per C \$
 Trucking \$
 Pav't Patch \$
 Tap by Gifford & Co \$
 4-18-66. \$
 O'head \$
 \$

Maple St. Pl. Ave. No. 216

Name of Owner Swift & Co.

Labor and Mat'l. Report Apr. 18 1966

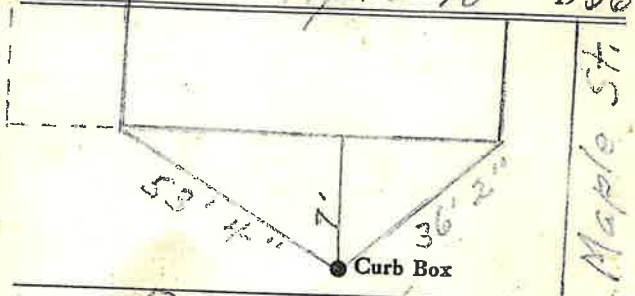

4" Main Elev. of Main at tap 6 1/2'

Gate at • Gate at

• Curb Box
 This Tap on Prospect St.